

RAIL RUNNER LT

ALL POSITION WELDING AND CUTTING TRAVEL CARRIAGE

The Steelmax **Rail Runner LT** is a digitally controlled rail mounted travel carriage designed for the mechanization of welding and thermal cutting processes. Mechanized control of the welding or cutting torch allows continuous welding or cutting, increasing operating factor and deposition rates in welding applications. The **Rail Runner LT** features a rack and pinion drive system with electronic speed control that produces weld bead geometry that is exact to your required specifications, reducing costly over welding and minimizing filler metal usage.

The **Rail Runner LT** can be used with semi-flexible rail for plate and tank applications with a minimum diameter of 32 ft (10 m) and can be adapted to ring rails for pipe and tube applications.

Standard ring rails are available for tube diameters from 8" (200 mm) up to 10 ft (3 m). Custom rolled rails can be used for tube diameters between 10 ft (3 m) and 32 ft (10 m).

An optional vacuum system allows the rails to attach to non-ferrous surfaces such as stainless steel and aluminum.

The **Rail Runner LT** is an economical system for a wide range of welding and cutting applications on flat or curved plate, tube and pipe.

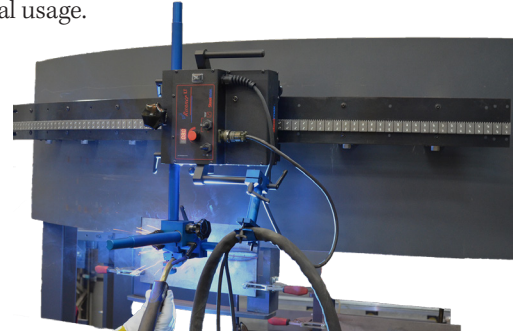

APPLICATIONS

- Trailer manufacturing
- Truck tanks
- Oil tanks
- Water storage tanks
- Pressure vessels
- Bridge girders
- Structural steel
- Structural towers
- Panel welding
- Transformers
- Shipyards
- Any application demanding long continuous welds

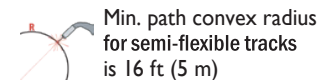
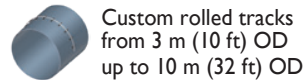
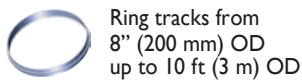
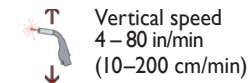
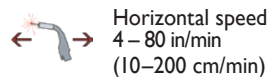
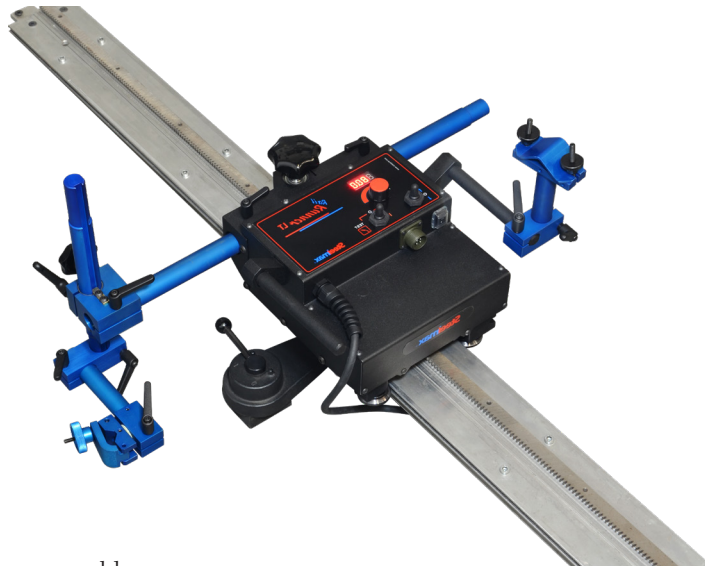

Steelmax®

The tools of innovation.

For ordering and customer service, or to request detailed product information or demonstration videos, contact:

RAIL RUNNER LT

FEATURES

- Compact, lightweight design
- Closed-loop encoder insures accurate speed control
- Rack and pinion drive
- Digital LED display for pre-setting travel speed
- Automatic arc on/off initiates welding and travel simultaneously
- Suitable for a variety of circumferential and irregular surface applications down to a minimum diameter of 8" (200 mm)
 - Ring rails for diameters from 8" (200 mm) OD up to 10 ft (3 m) OD
 - Custom rolled rails for diameters from 10 ft (3 m) OD up to 32 ft (10 m) OD
 - Semi-flexible rails can be bent to a minimum radius of 16 ft (5 m) without permanent deformation
- Gear-driven cross slide for precise torch adjustment
- Application-specific accessory kits for oxy-fuel, plasma, MIG/MAG and SAW processes

MIG/MAG Welding Torch Holding Kit SM-ZST-0570-03-03-00-0

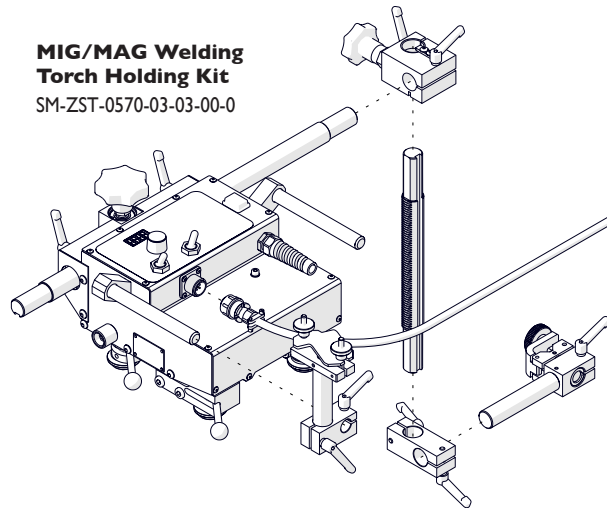

SAW Welding Torch Holding Kit SM-ZST-0570-03-04-00-0

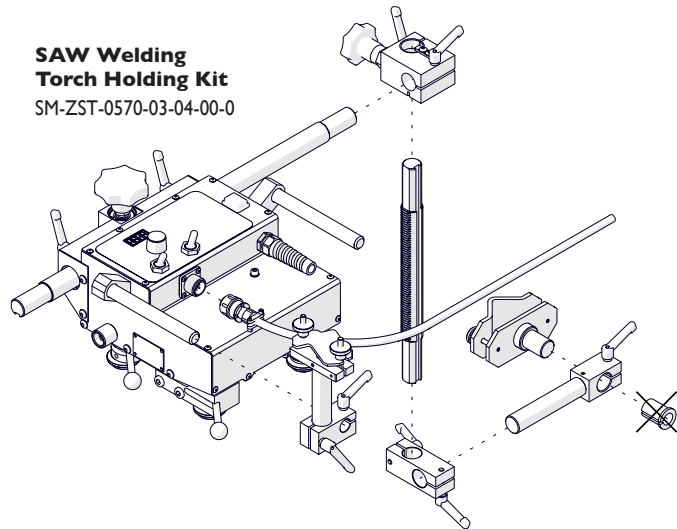

Oxy-fuel Cutting Torch Holding Kit SM-ZST-0570-03-01-00-0

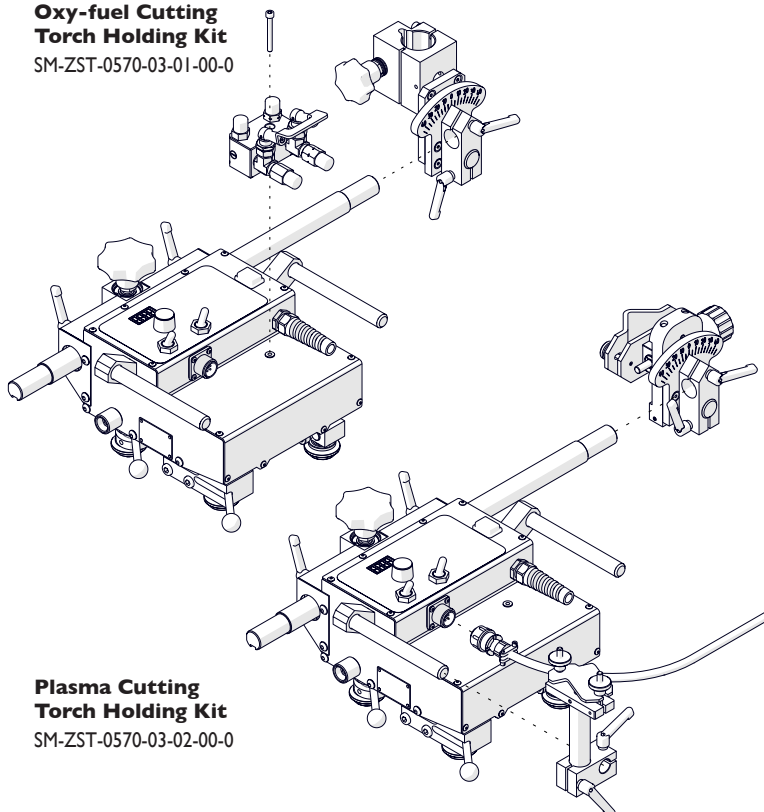

Plasma Cutting Torch Holding Kit SM-ZST-0570-03-02-00-0

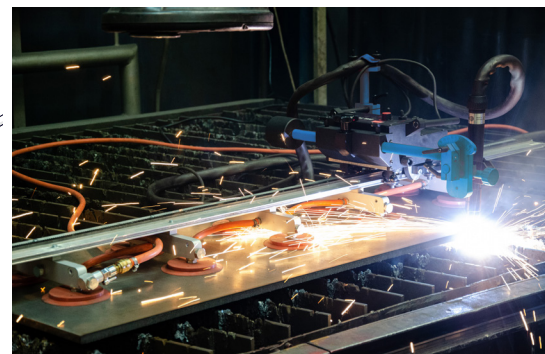
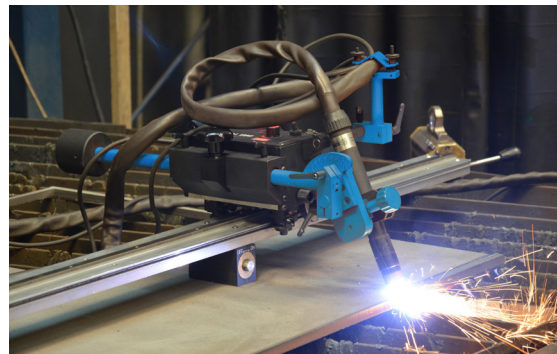

RAIL OPTIONS FOR RAIL RUNNER FAMILY OF CARRIAGES

Hi Flex Rail

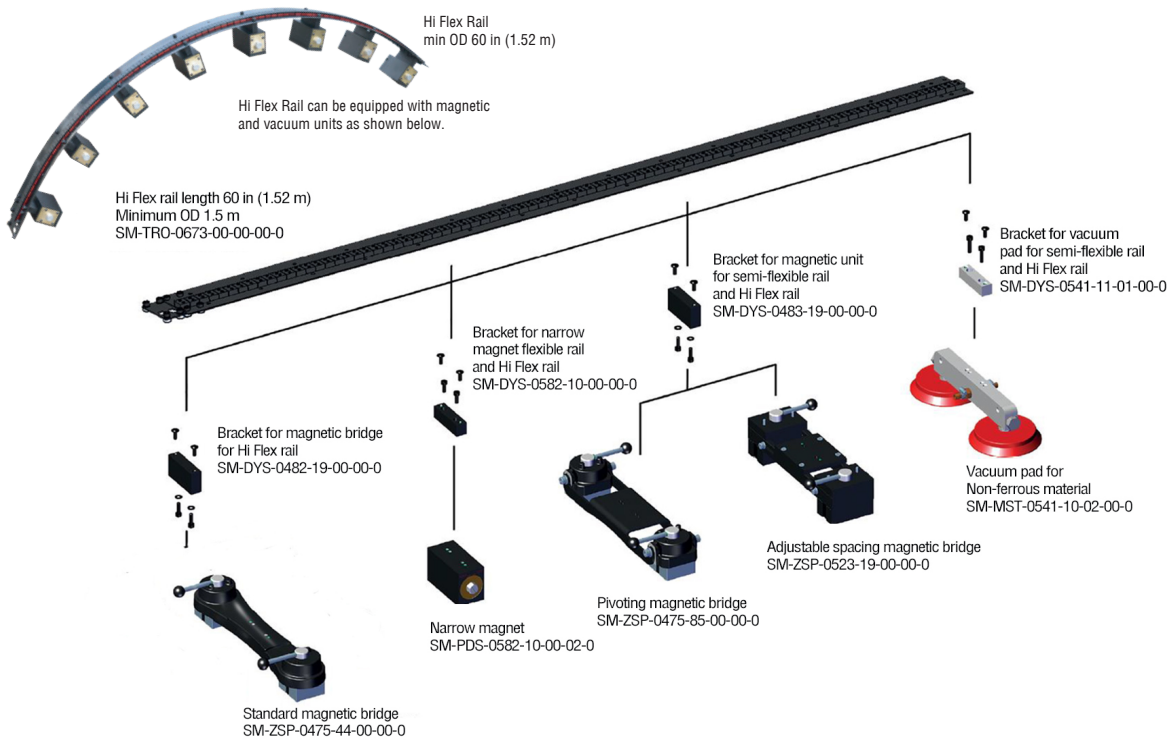

Set of Hi Flex Rail Guiding Rollers (4 pcs)
Product code: SM-ZSP-0673-07-00-00-0
The regular Rail Runner/ Rail Runner 2 rollers should be replaced with the optional Hi Flex Rail guiding rollers

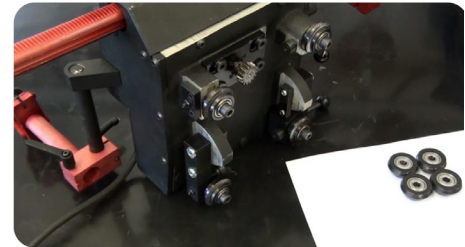

Ring Rails

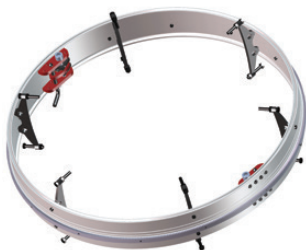

Available on request, diameter can be custom configured within the range from from 8" OD up to 10 ft OD (200 mm to 3000 mm).
Ring tracks can be equipped with various supports depending on the customer's needs.

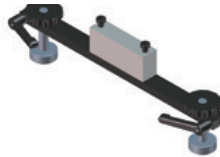

Ring Rail Support with Magnetic feet
SM-WSP-0523-14-12-00-0

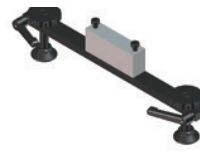

Ring Rail Support with plastic feet
SM-WSP-0523-14-11-00-0

DIGITALLY CONTROLLED TRACTOR FROM STEELMAX®

Rail Runner LT Technical Specifications

Voltage		115 - 230V 50 - 60 Hz
Power		66 Watts
Rail Options for Round Tube & Pipe	Ring Rails	8" OD to 10' OD (200 mm to 3m OD)
	Custom Rolled Rail	10' OD up to 32' OD (3m to 10m OD)
	Semi-Flexible Rail	Minimum Curvature Radius of 16' (5m)
Torch Types		Oxy-fuel, Plasma, MIG/MAG, SAW
Torch Diameter	Oxy-Fuel	up to 1-3/8" (35 mm)
	Plasma, SAW	up to 1-3/8" (35 mm)
	MIG/MAG	5/8" - 7/8" (16 - 22 mm)
Horizontal Pulling Force		67.5 Lbs
Vertical Pulling Force		45 Lbs
Horizontal Speed Range		4 - 80 in/min (10 - 200 mm/min)
Vertical Speed Range		4 - 80 in/min (10 - 200 mm/min)
Weight		22 Lbs (10 Kg)
Part Number		SM-WC-RR-LT

Standard shipping set:

- Rail Runner LT tractor
- 21" (540 mm) geared rack
- 6 mm hex wrench
- 10 ft (3 m) power cord
- Operator's Manual



Steelmax

The tools of innovation.

For ordering and customer service, or to request detailed product information or demonstration videos, contact:

877-833-5629

STEELMAX.COM

sales@Steelmax.com

Fax: 303-690-9172

RAIL OPTIONS FOR RAIL RUNNER FAMILY OF CARRIAGES

Semi Flex Rail

Semi-flexible rail 6.5 ft (2 m) long will flex at a minimum radius of 16 ft (5 m) without permanent deformation.
SM-PRW-0482-15-05-00-0

Semi-flexible rails can be custom rolled to a specific radius between 5 ft & 16 ft

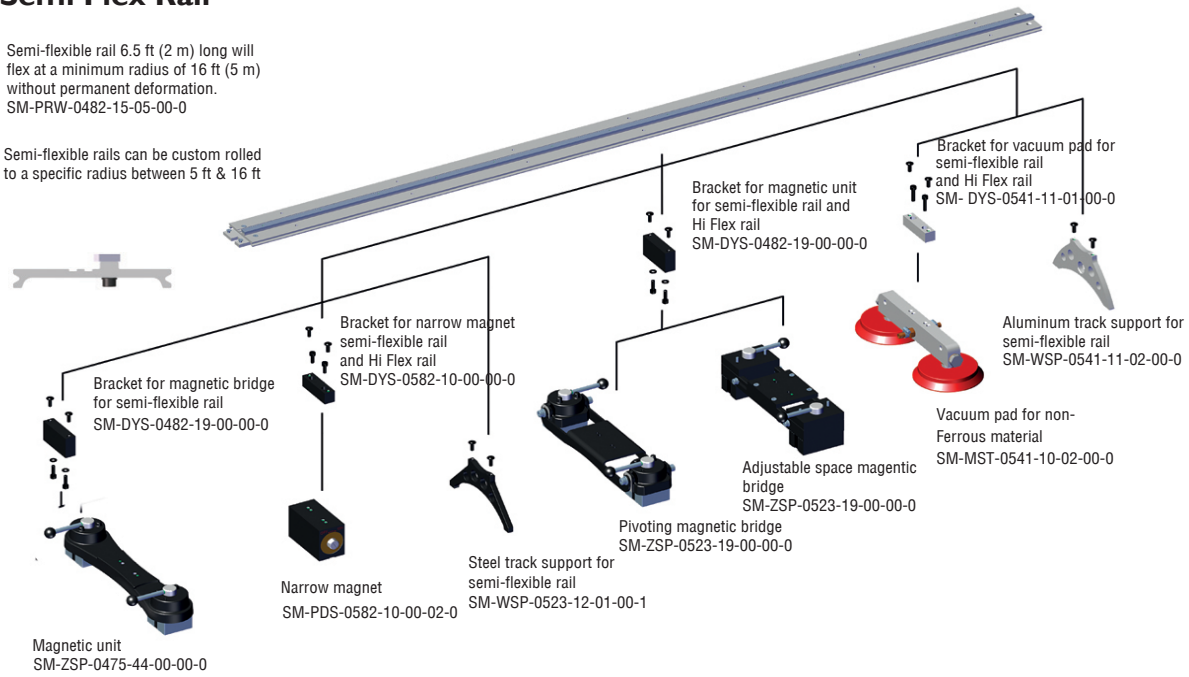

Rigid Rail

Rigid rail length 6.5 ft (2 m)
SM-PRW-0482-47-00-00-0

