

## RAIL RUNNER LT

### ALL POSITION WELDING AND CUTTING TRAVEL CARRIAGE

The Steelmax **Rail Runner LT** is a digitally controlled rail mounted travel carriage designed for the mechanization of welding and thermal cutting processes. Mechanized control of the welding or cutting torch allows continuous welding or cutting, increasing operating factor and deposition rates in welding applications. The **Rail Runner LT** features a rack and pinion drive system with electronic speed control that produces weld bead geometry that is exact to your required specifications, reducing costly over welding and minimizing filler metal usage.

The **Rail Runner LT** can be used with semi-flexible rail for plate and tank applications with a minimum diameter of 32 ft (10 m) and can be adapted to ring rails for pipe and tube applications.

Standard ring rails are available for tube diameters from 8" (200 mm) up to 10 ft (3 m). Custom rolled rails can be used for tube diameters between 10 ft (3 m) and 32 ft (10 m).

An optional vacuum system allows the rails to attach to non-ferrous surfaces such as stainless steel and aluminum.

The **Rail Runner LT** is an economical system for a wide range of welding and cutting applications on flat or curved plate, tube and pipe.

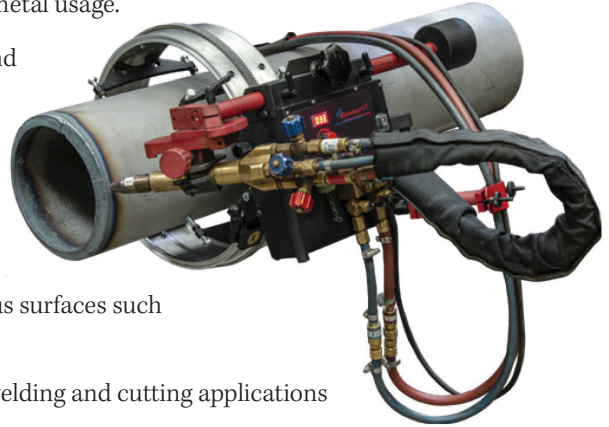

### APPLICATIONS

- Trailer manufacturing
- Truck tanks
- Oil tanks
- Water storage tanks
- Pressure vessels
- Bridge girders
- Structural steel
- Structural towers
- Panel welding
- Transformers
- Shipyards
- Any application demanding long continuous welds



Continuous welding



Horizontal speed  
4 – 80 in/min  
(10–200 cm/min)



Vertical speed  
4 – 80 in/min  
(10–200 cm/min)



Ring tracks from  
8" (200 mm) OD  
up to 10 ft (3 m) OD



Hi Flex Track  
min OD 1500 mm



Custom rolled tracks  
from 3 m (10 ft) OD  
up to 10 m (32 ft) OD



Min. path convex radius  
for semi-flexible tracks  
is 16 ft (5 m)

# Steelmax®

The tools of innovation.

# RAIL RUNNER LT

## FEATURES

- Compact, lightweight design
- Closed-loop encoder insures accurate speed control
- Rack and pinion drive
- Digital LED display for pre-setting travel speed
- Automatic arc on/off initiates welding and travel simultaneously
- Suitable for a variety of circumferential and irregular surface applications down to a minimum diameter of 8" (200 mm)
  - Ring rails for diameters from 8" (200 mm) OD up to 10 ft (3 m) OD
  - Custom rolled rails for diameters from 10 ft (3 m) OD up to 32 ft (10 m) OD
  - Semi-flexible rails can be bent to a minimum radius of 16 ft (5 m) without permanent deformation
- Gear-driven cross slide for precise torch adjustment
- Application-specific accessory kits for oxy-fuel, plasma, MIG/MAG and SAW processes

**MIG/MAG Welding  
Torch Holding Kit**  
SM-ZST-0570-03-03-00-0

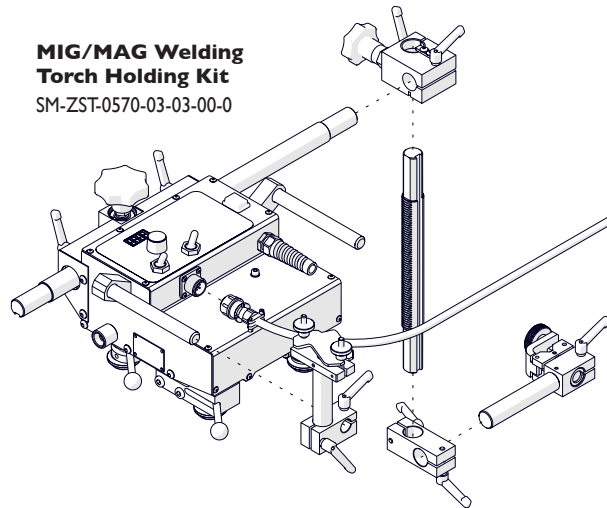

**SAW Welding  
Torch Holding Kit**  
SM-ZST-0570-03-04-00-0

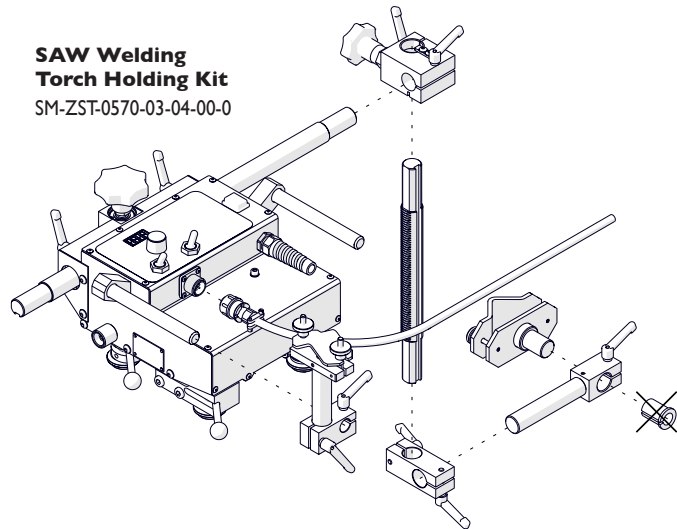

**Oxy-fuel Cutting  
Torch Holding Kit**  
SM-ZST-0570-03-01-00-0

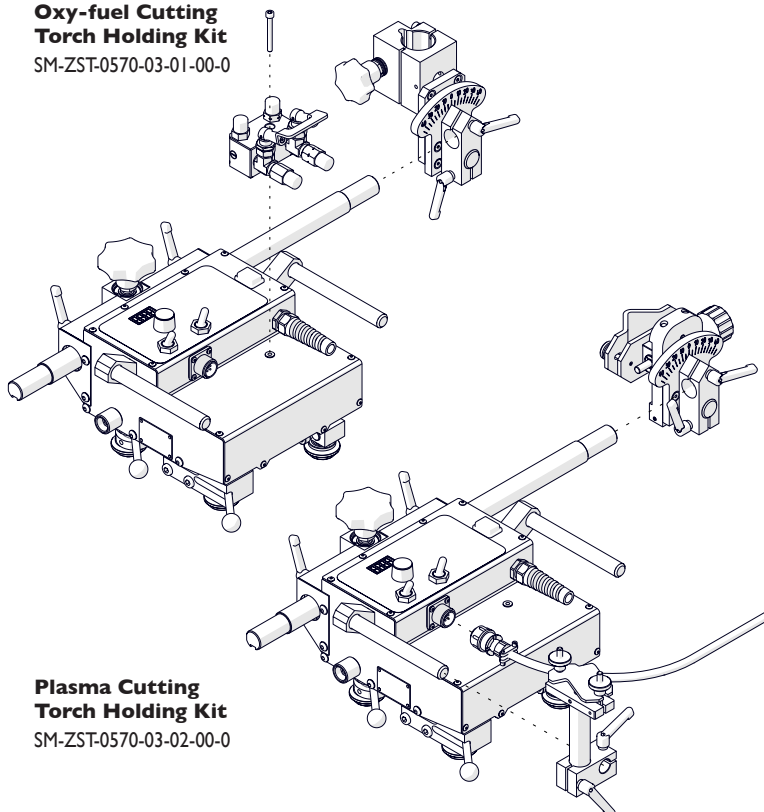

**Plasma Cutting  
Torch Holding Kit**  
SM-ZST-0570-03-02-00-0

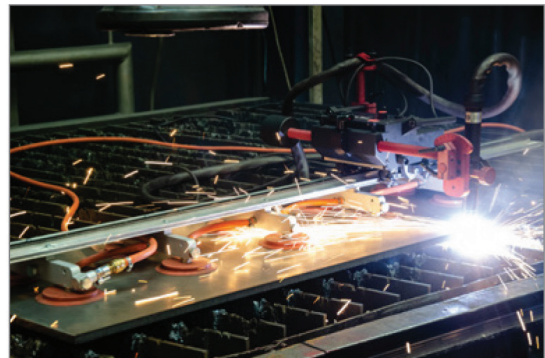

# DIGITALLY CONTROLLED TRACTOR FROM STEELMAX®

## Ring tracks



Available on request, diameter can be custom configured within the range from 8" OD up to 10 ft OD (200 mm to 3000 mm).  
Ring tracks can be equipped with various supports depending on the customer's needs.



Support with bolts  
SM-WSP-0523-14-02-00-0

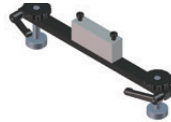

Support with magnets  
SM-WSP-0523-14-12-00-0

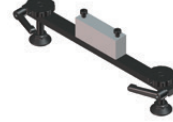

Support with plastic feet  
SM-WSP-0523-14-11-00-0

Rigid track length 6.5 ft (2 m)  
SM-PRW-0482-47-00-00-0

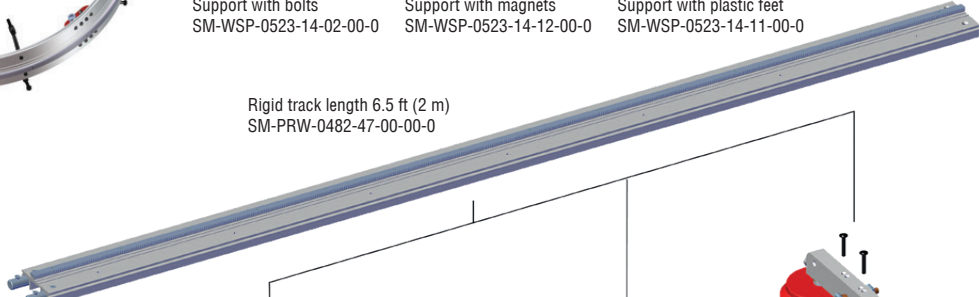

Bracket for magnetic unit  
for rigid track  
SM-DYS-0482-21-00-00-0



Narrow magnetic unit with hexagon  
SM-PDS-0582-10-00-02-0

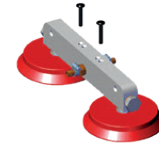

Vacuum modular unit  
SM-MST-0541-10-02-00-0

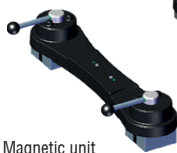

Magnetic unit  
SM-ZSP-0475-44-00-00-0



Heat-resistant  
magnetic unit  
SM-ZSP-0475-44-00-00-1

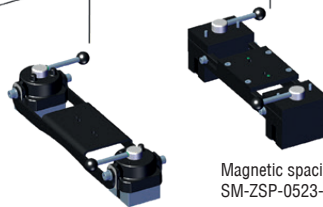

Magnetic spacing-adjustable unit  
SM-ZSP-0523-19-00-00-0



Magnetic pivoting unit  
SM-ZSP-0475-85-00-00-0

Semi-flexible track length 6.5 ft (2 m)  
Minimum 16 ft (5 m) curvature radius required  
SM-PRW-0482-15-05-00-0

Semi-flexible tracks can be custom rolled permanently within the radius range from 5 ft up to 16 ft (1.5 m up to 5 m)

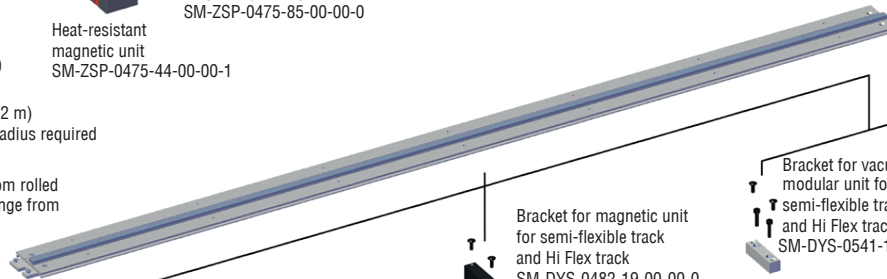

Bracket for magnetic unit  
for semi-flexible track  
and Hi Flex track  
SM-DYS-0482-19-00-00-0

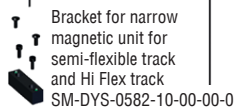

Bracket for narrow  
magnetic unit for  
semi-flexible track  
and Hi Flex track  
SM-DYS-0582-10-00-00-0



Bracket for magnetic unit  
for semi-flexible track  
and Hi Flex track  
SM-DYS-0482-19-00-00-0

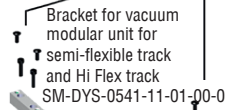

Bracket for vacuum  
modular unit for  
semi-flexible track  
and Hi Flex track  
SM-DYS-0541-11-01-00-0



Magnetic unit  
SM-ZSP-0475-44-00-00-0



Heat-resistant  
magnetic unit  
SM-ZSP-0475-44-00-00-1



Narrow magnetic  
unit with hexagon  
SM-PDS-0582-10-00-02-0

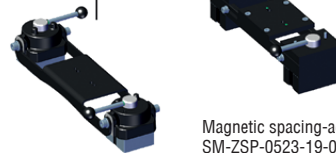

Magnetic spacing-adjustable unit  
SM-ZSP-0523-19-00-00-0



Magnetic pivoting unit  
SM-ZSP-0475-85-00-00-0

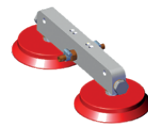

Vacuum modular unit  
SM-MST-0541-10-02-00-0

Aluminum track support  
for semi-flexible track  
SM-WSP-0541-11-02-00-0

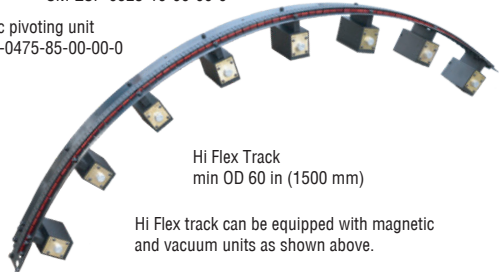

Hi Flex Track  
min OD 60 in (1500 mm)

Hi Flex track can be equipped with magnetic and vacuum units as shown above.

# DIGITALLY CONTROLLED TRACTOR FROM STEELMAX®

## Rail Runner LT Technical Specifications

Voltage		115 - 230V 50 - 60 Hz
Power		66 Watts
Rail Options for Round Tube & Pipe	Ring Rails	8" OD to 10' OD (200 mm to 3m OD)
	Custom Rolled Rail	10' OD up to 32' OD (3m to 10m OD)
	Semi-Flexible Rail	Minimum Curvature Radius of 16' (5m)
Torch Types		Oxy-fuel, Plasma, MIG/MAG, SAW
Torch Diameter	Oxy-Fuel	up to 1-3/8" (35 mm)
	Plasma, SAW	up to 1-3/8" (35 mm)
	MIG/MAG	5/8" - 7/8" (16 - 22 mm)
Horizontal Pulling Force		67.5 Lbs
Vertical Pulling Force		45 Lbs
Horizontal Speed Range		4 - 80 in/min (10 - 200 mm/min)
Vertical Speed Range		4 - 80 in/min (10 - 200 mm/min)
Weight		22 Lbs (10 Kg)
Part Number		SM-WC-RR-LT

### Standard shipping set:

- Rail Runner LT tractor
- 21" (540 mm) geared rack
- 6 mm hex wrench
- 10 ft (3 m) power cord
- Operator's Manual



**Steelmax**  
The tools of innovation.



For ordering and customer service, or to request detailed product information or demonstration videos, contact:

877-833-5629

STEELMAX.COM

sales@Steelmax.com

Fax: 303-690-9172