



The tools of innovation.

MODEL S9 XP

(Part Number: SM-S-9 XP)

9" METAL CUTTING CIRCULAR SAW OPERATOR'S MANUAL



TO REDUCE THE RISK OF INJURY, READ AND THOROUGHLY UNDERSTAND THIS OPERATOR'S MANUAL.



Always Wear Eye and
Ear Protection



Never Place
Hands Near
Cutting Area

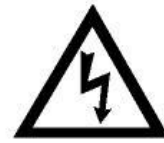

Line Voltage
Present

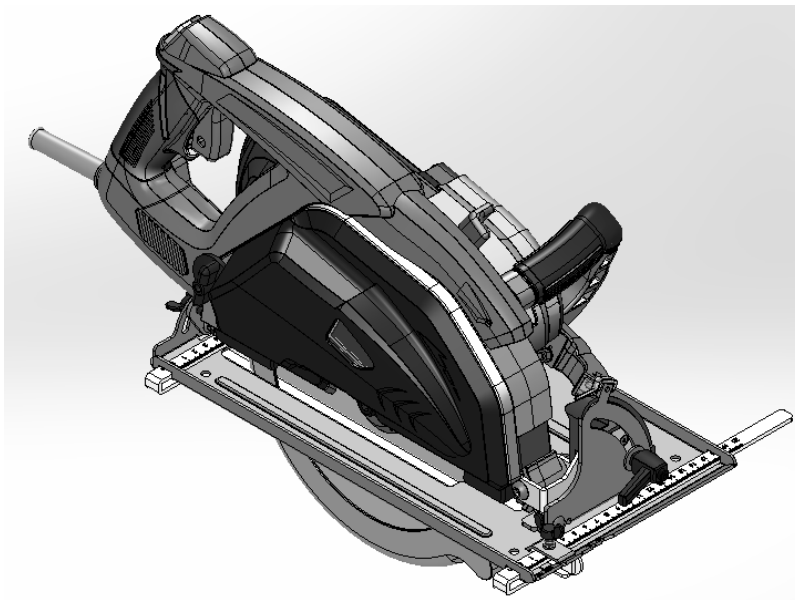

WWW.STEELMAX.COM



The tools of innovation.

Steelmax S9 XP Portable Metal Cutting Circular Saw

Congratulations on your purchase of a Steelmax® portable metal cutting saw. Please register your product on our web site at www.steelmax.com/product-registration. Doing so will validate your machine's warranty period and ensure prompt service if needed. We sincerely thank you for selecting a product from Steelmax.

CONTENTS

Intended Use and General Safety Guidelines	1
Specific Safety Rules for Metal Cutting Saws.....	4
Exploded Parts Diagram	8
Parts List	9
Steelmax S9 XP Operation	
Included items	11
Saw Blade Installation/Replacement	12
Making Plunge Cuts.....	14
Setting Bevel Angle for Bevel Cuts	15
Laser Guide Use and Adjustment	15
Aligning Laser Guide Line	16
Using LED Light.....	18
Cutting Depth Adjustment	18
Saw Trigger Switch Operation.....	19
Proper Saw Operation.....	19
Overload Protection	20
Saw Guide ruler	20
Sighting Notch	21
Chip Removal	21
Saw Maintenance	22
Troubleshooting	24
Saw Specifications	25
Warning Symbols and Precautions	26



The tools of innovation.

STEELMAX LIMITED WARRANTY

Within twelve (12) months from the original date of purchase Steelmax will repair or replace any machine tool found to be defective in materials or workmanship, provided the product working registration card has been returned to Steelmax within thirty (30) days of the purchase date. This warranty is void if the tool being returned has been used beyond the recommendations in this Operator's Manual or if the machine has been damaged by accident, neglect, improper service, or other causes not arising out of defects in materials or workmanship. This warranty does not apply to machines and/or components which have been altered, changed, or modified in any way, or subjected to use beyond recommended capacities and specifications. Electrical components are subject to respective manufacturers warranties. All goods returned defective shall be returned prepaid freight to Steelmax, which shall be the buyer's sole and exclusive remedy for defective goods. Steelmax reserves the right to optionally repair or replace the machine with the same or equivalent item. There is no warranty for any consumable items, including, without limitation, saw blades, annular cutters, abrasive belts and cutting inserts. All machines must have the consumables used when the machine failed installed to determine if the machine has been overused or if it falls under Steelmax's warranty replacement program for defects in material and workmanship. In no event shall Steelmax be liable for loss or damage resulting directly or indirectly from the use of the merchandise or from any other cause. Steelmax is not liable for any costs incurred on such goods or consequential damages. No officer, employee or agent of Steelmax is authorized to make oral representations of fitness or to waive any of the foregoing terms of sale and none shall be binding on Steelmax.

STEELMAX RESERVES THE RIGHT TO MAKE IMPROVEMENTS AND MODIFICATIONS TO DESIGN AND SPECIFICATIONS WITHOUT PRIOR NOTICE. IN ADDITION, STEELMAX RESERVES THE RIGHT TO MODIFY THESE TERMS AND CONDITIONS WITHOUT PRIOR NOTICE.



The tools of innovation.

Intended Use and General Safety Guidelines

The Steelmax S9 XP Metal Cutting Saw is designed to rapidly cut mild steel and other similar materials without heating either the saw blade or the material being cut. The S9 XP can easily cut mild steel sheet metal up to 1/4" (6 mm) thick.



WARNING! To reduce the risk of injury, read and thoroughly understand this Operator's Manual.



WARNING! Read all safety warnings and all instructions thoroughly and carefully. Failure to follow the warnings and instructions may result in electric shock, fire and/or severe injury.

SAVE THIS OPERATOR'S MANUAL FOR FUTURE REFERENCE

Work Area Safety

- Keep work area clean and well lit. **Cluttered or dark areas invite accidents.**
- Do not operate power tools in explosive atmospheres, such as in the presence of flammable liquids, gases or dust. Power tools create sparks which may ignite the dust or fumes.
- Keep children and bystanders away while operating a power tool. **Distractions can cause you to lose control of the saw or the material being cut.**

Electrical Safety

- Grounded tools must be plugged into an outlet properly installed and grounded in accordance with all codes and ordinances. Never remove the grounding prong or modify the plug in any way. Do not use adapter plugs. Check with a qualified electrician if you are in doubt as to whether the outlet is properly grounded. **If the tool should electrically malfunction or break down, grounding provides a low resistance path to carry electricity away from the user.**
- Don't expose power tools to rain or wet conditions. Water entering a power tool will increase the risk of electric shock.
- Do not abuse the cord. Never use the cord to carry the tools or pull the plug from the outlet. Keep cord away from heat, oil, sharp edges or moving parts. **Replace damaged cords immediately. Damaged cords increase the risk of electric shock.**
- When operating a power tool outside, use an outdoor extension cord marked "W-A" or "W." **These cords are rated for outdoor use and reduce the risk of electric shock.**
- **When using an extension cord, be sure to use one heavy enough to carry the current your product will draw. An undersized cord will cause line voltage to drop, resulting in loss of power and overheating. The recommended minimum is a 14-gauge extension cord not exceeding 50 feet.**



The tools of innovation.

Personal Safety

- Stay alert, watch what you are doing and use common sense when operating a power tool. Do not use tool while tired or under the influence of drugs, alcohol, or medication. **A moment of inattention while operating power tools may result in serious personal injury.**
- Dress properly. Do not wear loose clothing or jewelry. Contain long hair. Keep your hair, clothing, and gloves away from moving parts. **Loose clothes, jewelry, or long hair can be caught in moving parts.**
- Avoid accidental starting. Be sure switch is off before plugging in. **Carrying tools with your finger on the switch or plugging in tools that have the switch on invites accidents.**
- Remove adjusting keys or switches before turning the tool on. A wrench or a key that is left attached to a rotating part of the tool may result in personal injury.
- Do not overreach. Keep proper footing and balance always. **Proper footing and balance enables better control of the tool.**
- Use safety equipment. Always wear eye and ear protection. **Dust mask, non-skid safety shoes and hard hat should be used as appropriate for conditions.**

Tool Use and Care

- Use clamps or other practical way to secure and support the workpiece to a stable platform. **Holding the work by hand or against your body is unstable and may lead to loss of control.**
- Do not force tool. Use the correct tool for your application. **The correct tool will do the job better and more safely.**
- Do not use tool if switch does not turn it on or off. **Any tool that cannot be controlled with the switch is dangerous and must be repaired.**
- Disconnect the plug from the power source before making any adjustments, changing accessories, or storing the tool. **Such preventive safety measures reduce the risk of starting the tool accidentally.**
- Store idle tools out of reach of children and other untrained persons. **Tools are dangerous in the hands of untrained users.**
- Maintain tools with care. Keep cutting tools sharp and clean. **Properly maintained tools, with sharp cutting edges are less likely to bind and are easier to control.**
- Check for misalignment or binding of moving parts, breakage of parts, and any other condition that may affect the tools operation. If damaged, have the tool serviced before using. **Many accidents are caused by poorly maintained tools.**
- Use only accessories that are recommended by the manufacturer for your model. **Accessories that may be suitable for one tool may become hazardous when used on another tool.**



The tools of innovation.

Service

- Tool service must be performed only by qualified repair personnel. Service or maintenance performed by unqualified personnel could result in a risk of injury.
- When servicing a tool, use only identical replacement parts. Follow instructions in the Maintenance section of this manual. **Use of unauthorized parts or failure to follow Maintenance Instructions may create a risk of electric shock or injury and will void the warranty.**



The tools of innovation.

Specific Safety Rules for Metal Cutting Saws

- Only use Steelmax® saw blades. Unauthorized blades may be dangerous!
- Keep saw blades securely fastened. Check blade flanges for debris before installing a new blade.
- Do not use dull or broken blades. Check blades often for condition and wear.
- Check chip collector cover for proper fit to minimize the risk of flying debris.
- Beware of ejecting chips. They become HOT during cutting.
- Always make provisions for safe handling of excess material.
- Keep bottom of base plate free from dirt and other debris.

Additional copies of this manual are available on our web site at: www.steelmax.com or by contacting us directly at (303) 690-9146

- DANGER! Keep hands and body away from and to the side of the blade. Contact with blade will result in severe injury.

- WARNING! To reduce the risk of injury, check lower guard. It must close quickly and automatically. Hold saw with both hands. Support and clamp work. Wear eye and ear protection.

Additional Specific Safety Rules:

DANGER! Keep hands away from cutting area and blade. Keep your second hand on auxiliary handle, or motor housing. If both hands are holding the saw, they cannot be cut by the blade.

- Keep your body positioned to either side of the saw blade, but not in line with the saw blade. KICKBACK could cause the saw to jump backwards. (See "Causes and Prevention of Kickback.")
- Do not reach underneath the work. The guard cannot protect you from the blade below the work.
- Check lower guard for proper closing before each use. Do not operate saw if lower guard does not move freely and close automatically. Never clamp or tie the lower guard into the open position. If saw is accidentally dropped, lower guard may be bent. Raise the lower guard and make sure it moves freely and does not touch the blade or any other part, in all angles and depths of cut.
- Check the operation and condition of the lower guard spring. If the guard and the spring are not operating properly, they must be serviced before use. Lower guard may operate sluggishly due to damaged parts, gummy deposits, or a buildup of debris.
- Always observe that the lower guard is covering the blade before placing saw down on bench or floor. An unprotected, coasting blade will cause the saw to walk backwards, cutting



The tools of innovation.

whatever is in its path. Be aware of the time it takes for the blade to stop after switch is released.

- NEVER hold piece being cut in your hands or across your leg. It is important to support the work properly to minimize body exposure, blade binding, or loss of control.
- Hold tool by insulated gripping surfaces when performing an operation where the cutting tool may contact hidden wiring or its own cord. Contact with a "live" wire will also make exposed metal parts of the tool "live" and shock the operator.
- When ripping always use a rip fence or straight edge guide. This improves the accuracy of cut and reduces the chance for blade binding.
- Always use blades with correct size and shape (diamond vs. round) arbor holes. Blades that do not match the mounting hardware of the saw will run eccentrically, causing loss of control.
- Never use damaged or incorrect blade washer or bolts. The blade washer and bolt were specially designed for your saw, for optimum performance and safety of operation.

LASER ALIGNMENT GUIDE PRECAUTIONS



DANGER! LASER RADIATION. AVOID DIRECT EYE EXPOSURE. DO NOT STARE INTO THE LASER LIGHT SOURCE.

Never aim light at another person or object other than the workpiece. Laser light can damage your eyes.



WARNING!

DO NOT USE TINTED GLASSES TO ENHANCE THE LASER LIGHT. Tinted glasses will reduce overall vision for the application and interfere with the normal operation of the tool.



The tools of innovation.

WARNING!

NEVER AIM THE BEAM AT A WORKPIECE WITH A REFLECTIVE SURFACE. Highly polished or similar reflective surfaces are not recommended for laser use where eye exposure is possible due to reflection. These surfaces could reflect the beam back toward the operator or bystanders. **ALWAYS CONSIDER THE PATH OF POSSIBLE BEAM DEFLECTION.**

CAUSES AND PREVENTION OF KICKBACK

Kickback is a sudden reaction to a pinched, bound or misaligned saw blade, causing an uncontrolled saw to lift up and out of the workpiece toward the operator. When the blade is pinched or bound tightly by the kerf (saw cut) closing down, the blade stalls and the motor reaction drives the unit rapidly back toward the operator. If the blade becomes twisted or misaligned in the cut, the teeth at the back edge of the blade can dig into the top surface of the material causing the blade to climb out of the kerf and the saw to jump back toward operator. Kickback is the result of tool misuse and/or incorrect operating procedures or conditions and can be avoided by taking proper precautions as given below:

Maintain a firm grip with both hands on the saw and position your body and arm to allow you to resist KICKBACK forces. KICKBACK forces can be controlled by the operator, if proper precautions are taken.

When blade is binding, or when interrupting a cut for any reason, release the trigger and hold the saw motionless in the material until the blade comes to a complete stop. Never attempt to remove the saw from the work or pull the saw backward while the blade is in motion or KICKBACK may occur. Investigate and take corrective actions to eliminate the cause of blade binding.

When restarting a saw in the workpiece, center the saw blade in the kerf and check that saw teeth are not engaged into the material. If saw blade is binding, it may walk up or KICKBACK from the workpiece as the saw is restarted.

Support large panels to minimize the risk of blade pinching and KICKBACK. Large panels tend to sag under their own weight. Supports must be placed under the panel on both sides, near the line of cut and near the edge of the panel.

Never attempt to cut with a dull or damaged blade. Dull or improperly set blades produce a narrow kerf which leads to excessive friction, blade binding and KICKBACK.

Blade depth and bevel adjusting locking levers must be tight and secure before making a cut. If blade adjustment shifts while cutting, it may cause binding and KICKBACK.

Lower Guard Safety Instructions

- Check lower guard for proper closing before each use. Do not operate the saw if lower guard does not move freely and close instantly. Never clamp or tie the lower guard into the open



The tools of innovation.

position. If saw is accidentally dropped, lower guard may be bent. Raise the lower guard with the retracting handle and make sure it moves freely and does not touch the blade or any other part, in all angles and depths of cut.

- Check the operation of the lower guard spring. If the guard and the spring are not operating properly, they must be serviced before use. Lower guard may operate sluggishly due to damaged parts, gummy deposits, or a build-up of debris.
- Lower guard manually only for special cuts such as “plunge cuts” and “compound cuts.” Raise lower guard by retracting handle. As soon blade enters the material, release the lower guard. For all other sawing, the lower guard should operate automatically.
- Always observe that the lower guard is covering the blade before placing saw down on bench or floor. An unprotected, spinning blade will cause the saw to walk backwards, cutting whatever is in its path. Be aware of the time it takes for the blade to stop after switch is released.

Additional Safety Instructions

- Use clamps or another practical way to secure and support the workpiece to a stable platform. Holding the work by hand or against your body leaves it unstable and may lead to loss of control.
- Keep your body positioned to either side of the blade, but not in line with the saw blade. KICKBACK could cause the saw to jump backwards (see Causes and Operator Prevention of Kickback and KICKBACK).
- Make sure nothing interferes with the movement of the lower blade guard.
- Make sure the saw is clean before use.
- Stop using this saw and have it properly serviced if any unusual noise or abnormal operation occurs.
- Be sure all components are mounted properly and securely before using tool.
- Wait until the motor has reached full speed before starting a cut.
- Keep handles dry, clean and free of oil and grease. Hold the tool firmly with both hands when in use.
- Always be alert, especially during repetitive, monotonous operations. Always be sure of position of your hands relative to the blade.
- Stay clear of end pieces that may fall after cutting off. They may be sharp and/or heavy. Serious personal injury may result.
- Replace or repair damaged cords. Make sure your extension cord is in good condition. Use only 3-wire (minimum 14 gauge) extension cords that have 3-prong grounding-type plugs and 3-pole receptacles that accept the tool’s plug.

S9 XP Parts Diagram

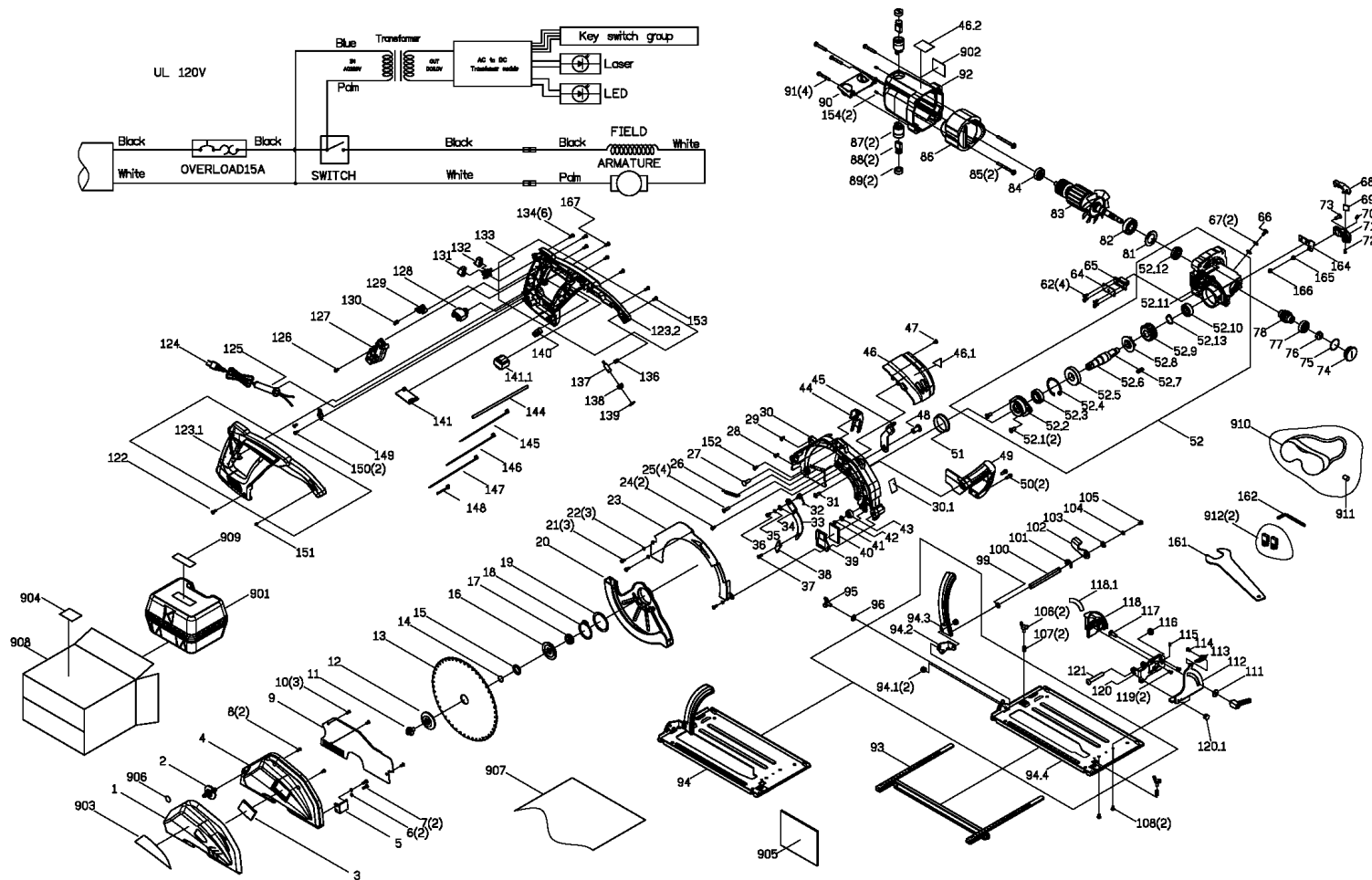



The tools of innovation.

Steelmax S9 XP Parts List

Ref. No.	Steelmax Part No.	Description	Quantity	Ref. No.	Steelmax Part No.	Description	Quantity
001	SMS9XP-1	Set Flute Cover ABS, PMS300C	1	045	SMS9XP-45	Blade Guard Push Lever	1
002	SMS9XP-2	Pivot	1	046	SMS9XP-46	Air Baffle Cover	1
003	SMS9XP-3	Glass (5mm)	1	046.1	SMS9XP-46.1	Heat Non-touchable Warning Label	1
004	SMS9XP-4	Dust Cover Set	1	046.2	SMS9XP-46.2	Laser Radiation Warning Label	1
005	SMS9XP-5	Dust Cover Hook Plate	1	047	SMS9XP-47	Cross Recessed Truss Head Screw	1
006	SMS9XP-6	Lock Washer	2	048	SMS9XP-48	Guard Pivot Screw	1
007	SMS9XP-7	Bolt: M4x0.7,10mm, Panhead Screw: Phillips	2	049	SMS9XP-49	Grasp Handle	1
008	SMS9XP-8	Flat Head Screw	2	050	SMS9XP-50	Hex SOC Head Screw	2
009	SMS9XP-9	Dust Cover Plate	1	051	SMS9XP-51	Washer	1
010	SMS9XP-10	Flat Head Screw	3	052	SMS9XP-52	Gear Box Assy	1
011	SMS9XP-11	Arbor Bolt (Blade Bolt)	1	052.1	SMS9XP-52.1	Flat Head Screw	2
012	SMS9XP-12	Flange	1	052.2	SMS9XP-52.2	Bearing Base	1
014	SMS9XP-14	O-Ring	1	052.3	SMS9XP-52.3	Ball Bearing	1
015	SMS9XP-15	Washer	1	052.4	SMS9XP-52.4	Inretaining Rings	1
016	SMS9XP-16	Blade Washer	1	052.5	SMS9XP-52.5	Oil Seal	1
017	SMS9XP-17	Spacer Ring	1	052.6	SMS9XP-52.6	Jackshaft	1
018	SMS9XP-18	External Retaining Ring	1	052.7	SMS9XP-52.7	Key	1
019	SMS9XP-19	Washer	1	052.8	SMS9XP-52.8	Oil Baffle	1
020	SMS9XP-20	Lower Guard	1	052.9	SMS9XP-52.9	Worm Wheel	1
021	SMS9XP-21	Bolt: M4x0.7,10mm, Pan Head Screw: Phillips	3	052.10	SMS9XP-52.10	Ball Bearing	1
022	SMS9XP-22	Lock Washer	3	052.11	SMS9XP-52.11	Gear Housing	1
023	SMS9XP-23	Inner Blade Guard	1	052.12	SMS9XP-52.12	Oil Seal	1
024	SMS9XP-24	Screw (Self-tapping, Clamp)	2	052.13	SMS9XP-52.13	C-Ring (Output Shaft)	1
025	SMS9XP-25	Screw	4	062	SMS9XP-62	Panhead Screw	4
026	SMS9XP-26	Spring	1	064	SMS9XP-64	Oil Seal	1
027	SMS9XP-27	Bolt, Flat Head	1	065	SMS9XP-65	Oil Seal Box	1
028	SMS9XP-28	Screw (Self-Tapping, Clamp)	1	066	SMS9XP-66	Screw	1
029	SMS9XP-29	Screw (Self-Tapping, Clamp)	1	067	SMS9XP-67	Washer	2
030	SMS9XP-30	Upper Guard	1	068	SMS9XP-68	LED Light Cap	1
030.1	SMS9XP-30.1	Laser LED Pointing Warning Label	1	069	SMS9XP-69	LED Cover	1
031	SMS9XP-31	Self-Tapping Screw	1	070	SMS9XP-70	LED Light	1
032	SMS9XP-32	Torsion Spring	1	071	SMS9XP-71	LED Seat	1
033	SMS9XP-33	Blade Guard Lifter	1	072	SMS9XP-72	Screw: M3x1.06,8mm, Panhead: Phillips, C	1
034	SMS9XP-34	Flat Washer	1	073	SMS9XP-73	Panhead Screw	1
035	SMS9XP-35	Lock Washer	1	074	SMS9XP-74	Nylon Screw Plugs	1
036	SMS9XP-36	Cross Recessed Truss Head Screw	1	075	SMS9XP-75	O-Ring	1
037	SMS9XP-37	Cross Recessed Truss Head Screw	1	076	SMS9XP-76	M10 x 1.5 Lock Nut	1
038	SMS9XP-38	Blade Guard Lifting Block	1	077	SMS9XP-77	Ball Bearing	1
039	SMS9XP-39	Lens Holding Plate	1	078	SMS9XP-78	Worm Gear	1
040	SMS9XP-40	Glass	1	081	SMS9XP-81	Oil Seal Plate	1
041	SMS9XP-41	Cross Recessed Truss Head Screw	1	082	SMS9XP-82	Ball Bearing	1
042	SMS9XP-42	Flat Washer	1	083	SMS9XP-83	Armature Assembly Set	1
043	SMS9XP-43	Cushion	1	084	SMS9XP-84	Ball Bearing	1
044	SMS9XP-44	Wire Cap	1	085	SMS9XP-85	Panhead Self-Tapping Screw / Washer	2



The tools of innovation.

Steelmax S9 XP Parts List (Cont'd)

Ref. No.	Steelmax Part No.	Description	Quantity	Ref. No.	Steelmax Part No.	Description	Quantity
086	SMS9XP-86	Field Assembly Set	1	126	SMS9XP-126	Screw (Self-Tapping, Clamp)	1
087	SMS9XP-87	Carbon Brush Holder	2	127	SMS9XP-127	Switch	1
088	SMS9XP-88	Carbon Brush	2	128	SMS9XP-128	Overload Protection	1
089	SMS9XP-89	Carbon Brush Cap	2	129	SMS9XP-129	Lock Button	1
090	SMS9XP-90	Reinforce Plate	4	130	SMS9XP-130	Spring	1
091	SMS9XP-91	Panhead M5 Screw + Washer	1	131	SMS9XP-131	LED Button	1
092	SMS9XP-92	Motor Housing	1	132	SMS9XP-132	Laser Button	1
093	SMS9XP-93	Guide Ruler	1	133	SMS9XP-133	Button Switch Assembly	1
094	SMS9XP-94	Parallel Plate Assembly Set	1	134	SMS9XP-134	Screw (Self-Tapping, Clamp)	6
094.1	SMS9XP-94.1	Rivet	1	136	SMS9XP-136	Spring	1
094.2	SMS9XP-94.2	Bevel Plate	1	137	SMS9XP-137	Laser Assembly Set	1
094.3	SMS9XP-94.3	Cutting Depth Scale Plate	1	138	SMS9XP-138	Laser Fixed Ring	1
094.4	SMS9XP-94.4	Base Plate	1	139	SMS9XP-139	O-Ring	1
095	SMS9XP-95	Wing Screw	1	140	SMS9XP-140	Terminal Block	1
096	SMS9XP-96	Washer	1	141	SMS9XP-141	AC to DC Transformer Modules	1
099	SMS9XP-99	Flat Washer	1	141.1	SMS9XP-141.1	Transformer	1
100	SMS9XP-100	Hex Bar	1	144	SMS9XP-144	Extruded Tubing	1
101	SMS9XP-101	E-Ring (ETW)	1	145	SMS9XP-145	Wiring Connector	1
102	SMS9XP-102	Secure Lever	1	146	SMS9XP-146	Wiring Connector	1
103	SMS9XP-103	Flat Washer	1	147	SMS9XP-147	Wiring Connector	1
104	SMS9XP-104	Lock Washer M5	1	148	SMS9XP-148	Wiring Connector	1
105	SMS9XP-105	Socket Screw	1	149	SMS9XP-149	Cord Clamp	1
106	SMS9XP-106	Wing Screw	2	150	SMS9XP-150	Self-Tapping Screw	2
107	SMS9XP-107	Spring Shaft Lock Button	2	151	SMS9XP-151	Set Screw	1
108	SMS9XP-108	Screw	2	152	SMS9XP-152	Self-Tapping Screw	1
110	SMS9XP-110	Lock Lever	1	153	SMS9XP-153	Self-Tapping Screw	1
111	SMS9XP-111	Flat Washer	1	154	SMS9XP-154	Set Screw	2
112	SMS9XP-112	Bevel Locking Plate	1	161	SMS9XP-161	32mm Open-end Wrench	1
113	SMS9XP-113	Miter Indicator	1	162	SMS9XP-162	6mm Hex Wrench	1
114	SMS9XP-114	Cross Recessed Truss Head Screw	1	164	SMS9XP-164	LED Fixed Plate	1
115	SMS9XP-115	Set Screw	1	165	SMS9XP-165	Lock Washer M5	1
116	SMS9XP-116	Nut Locking	1	166	SMS9XP-166	Nut Hex M5 x 0.8	1
117	SMS9XP-117	Carriage Screw	1	167	SMS9XP-167	Pinhead Cross Recess Screw	1
118	SMS9XP-118	Racket	1	901	SMS9XP-901	Plastic Carry Case	1
118.1	SMS9XP-118.1	Bevel Scale	1	902	SMS9XP-902	Motor Specification / Serial # Label	1
119	SMS9XP-119	Flat Head Screw	2	903	SMS9XP-903	Name Plate	1
120	SMS9XP-120	Bracket	1	904	SMS9XP-904	Shipping Marks	1
120.1	SMS9XP-120.1	Rivet	1	905	SMS9XP-905	Operator's Manual	1
121	SMS9XP-121	Socket Screw	1	906	SMS9XP-906	No Hands Warning Label	1
122	SMS9XP-122	Screw (Self-Tapping, Clamp)	1	907	SMS9XP-907	Plastic Bag	1
123	SMS9XP-123	Handle Assembly Set	1	908	SMS9XP-908	Carton Box	1
123.1	SMS9XP-123.1	Rear Handle - right	1	909	SMS9XP-909	Plastic Carry Case Label	1
123.2	SMS9XP-123.2	Rear Handle - Left	1	910	SMS9XP-910	Safety Goggles	1
124	SMS9XP-124	Power Cord	1	911	SMS9XP-911	Ear Plugs	1
125	SMS9XP-125	Cord Guard	1	912	SMS9XP-912	Carbon Brush	2



The tools of innovation.

STEELMAX S9 XP OPERATION

Your Steelmax® S9 XP® saw is shipped complete and protected inside a reusable carrying case. Remove all contents from the case and inspect to ensure no damage occurred during shipping.

INCLUDED ITEMS

DESCRIPTION	PART NUMBER	QUANTITY
S9 XP METAL CUTTING SAW	SM-S-9 XP	1
9" TCT SAW BLADE FOR MILD STEEL	SM-BL-09	1
OPERATOR'S MANUAL	N/A	1
CARRYING CASE	SMS9XP-901	1
SAFETY GOGGLES	SMS9XP-910	1
EARPLUGS (2)	SMS9XP-911	1
REPLACEMENT CARBON BRUSHES	SMS9XP-912	2
6MM ALLEN WRENCH	SMS9XP-162	1
EDGE GUIDE RULER	SMS9XP-93	1

WARNING:

For your own safety, never connect the plug to a power source outlet until all assembly steps are complete and you have read and understood the safety and operating instructions. The safety cover is attached to the saw for your protection. Should the safety cover become damaged, do not use the saw until the damaged cover has been replaced. If the safety cover becomes dirty, or chips adhere to it, clean the safety cover carefully with a damp cloth.



The tools of innovation.

Installing a New Saw Blade

WARNING: To prevent an accident or personal injury, always turn off the trigger switch and disconnect the power plug from the receptacle before removing or installing a blade. Only use Steelmax® blades designed for metal cutting saws. **DO NOT USE ABRASIVE WHEELS OR WOOD SAW BLADES ON YOUR METAL CUTTING SAW. USE ONLY STEELMAX 9" METAL CUTTING SAW BLADES. USE OF ABRASIVE WHEELS, WOOD SAW BLADES OR SMALLER OR LARGER SAW BLADES WILL VOID YOUR PRODUCT WARRANTY AND MAY RESULT IN PERSONAL INJURY.**

Check that the blade to be used is flat, sharp and free of damage or defects.

Blade Removal and Installation

1. Loosen lower guard lever (A). **Fig. 1.**

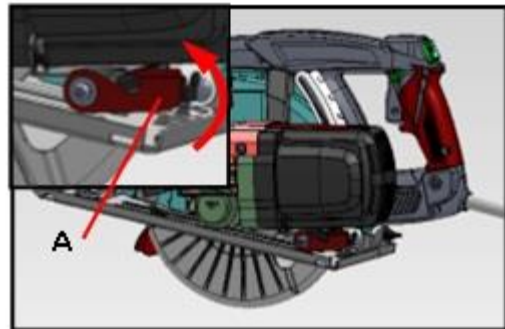

Fig.1

2. Open guide plate to maximum extent (B). **Fig. 2.**

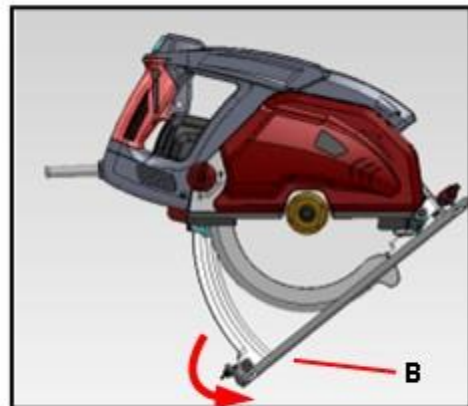

Fig.2

3. Use the included open-end wrench and Allen wrench to loosen the shaft screw (counter-clockwise). **Fig. 3.**

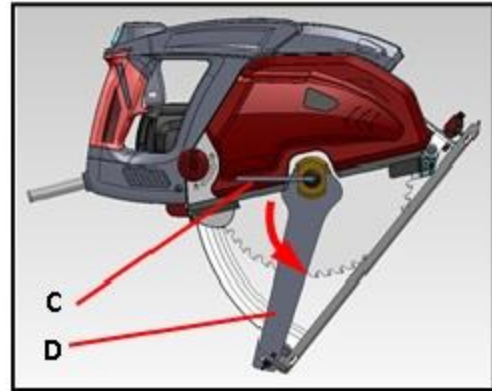

Fig.3

4. Remove wrenches and open blade guard to remove arbor screw, flange and blade. **Fig. 4.**

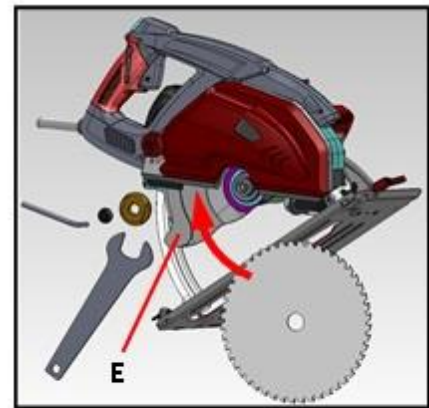

Fig.4

5. Install the new blade, flange and arbor screw in proper order and check for proper blade orientation. **Fig. 5.**

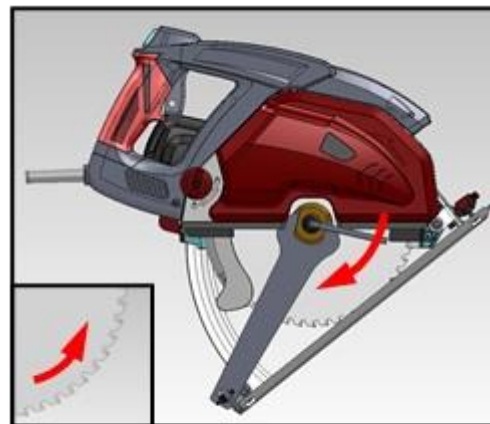

Fig.5

Making Plunge Cuts

Plunge or pocket cuts are made in the middle of a work piece when a cut cannot be started at the edge of the workpiece. Make certain that there are no hidden hazards under the workpiece before making a plunge or pocket cut.

1. Line up the saw sight line with your cutting line. Tilt the saw forward, firmly fixing the guide plate on the workpiece. The blade should be just above the the cutting line, but not touching the workpiece. Raise the lower blade guard (B) using the guard lever (A). **Fig. 6.**
2. Start the saw and allow the blade to reach maximum speed before beginning your cut. Use the front of the guide palte as a hinge and slowly lower the blade into the workpiece and release the guard lever (A).
3. Once the blade has fully penetrated the workpiece, advance the cut until complete. Release the trigger switch and let the blade come to a full stop before removing it from the workpiece.

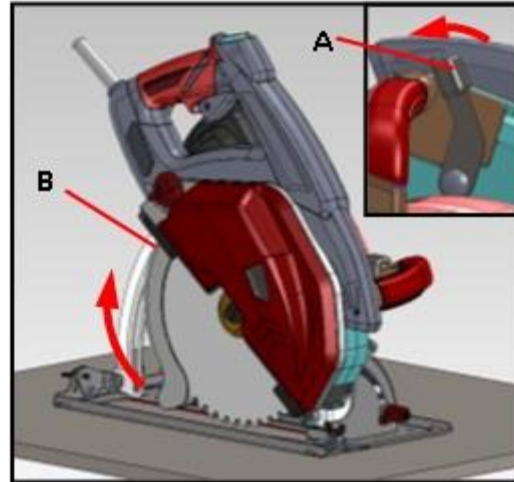

Fig.6

Setting Bevel Angle for Bevel Cuts

Release the lock lever (A) and the wing nut (B) to change the bevel plate angle between 0° and 45°. Once the angle is set, re-tighten the lock and lever and wing nut. **Fig. 7.**

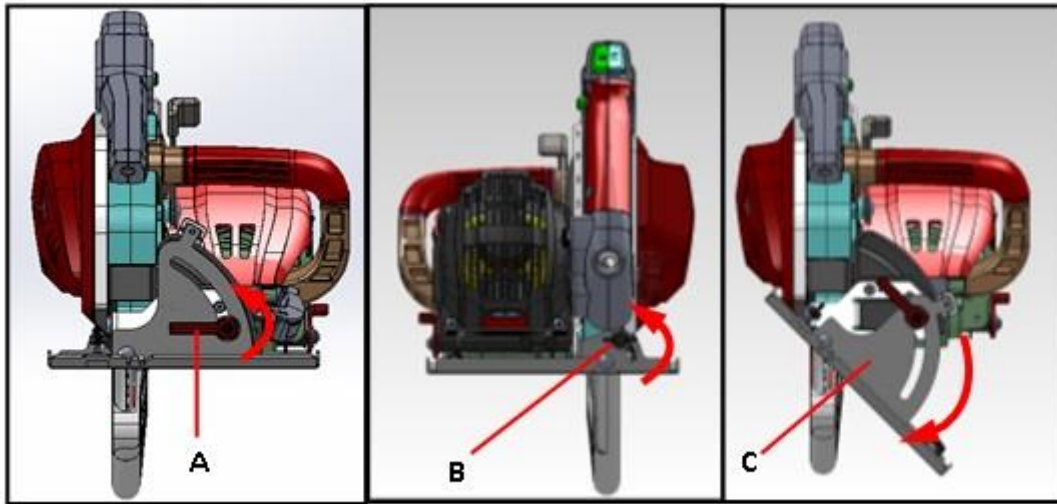

Fig7

Laser Guide Use and Adjustment

1. Plug power cord into appropriate power supply and press the bottom of the left button (A) to turn on the laser. Press again to turn laser off. **Fig.8.**

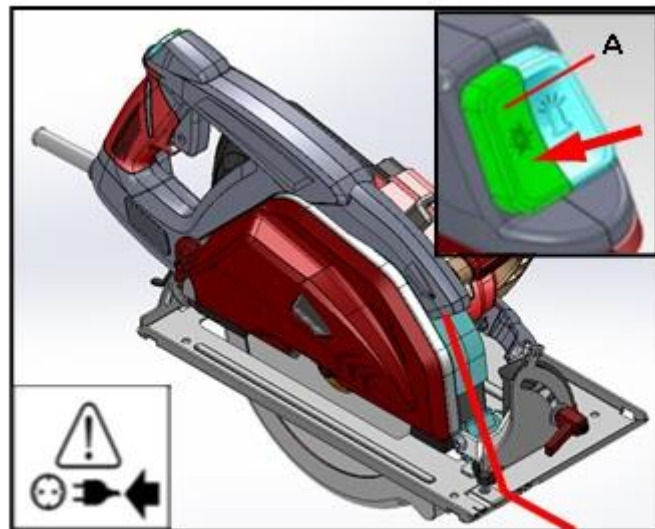

Fig.8

2. Laser guide automatically follows bevel angle. The laser will align with notch (B) at 0° and will align with notch (C) at 45°. **Fig. 9.**

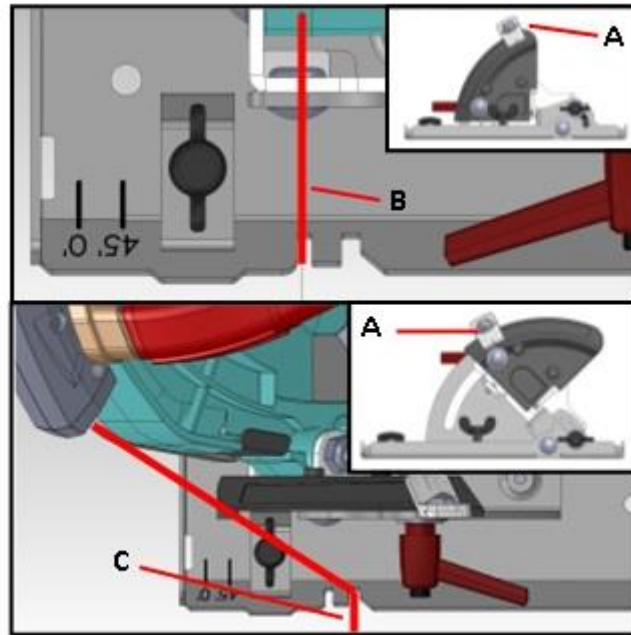

Fig.9

Aligning the Laser Guide Line

DANGER: Laser radiation. Avoid direct eye contact with light source.

WARNING: Use of controls or adjustments or performance of procedures other than those specified herein may result in hazardous radiation exposure. When adjusting the laser guide, make sure the saw trigger is not inadvertently engaged. **Fig. 10.** Serious injury could result.

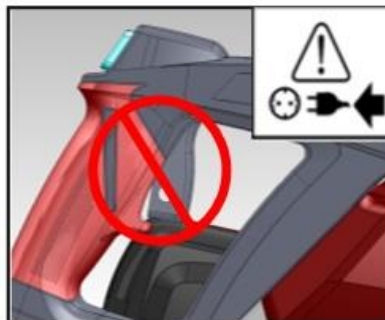

Fig.10

1. Adjusting the laser: Use an M2 Allen wrench to tighten or loosen the laser adjustment screw (A) to adjust the laser beam width. **Fig.11**

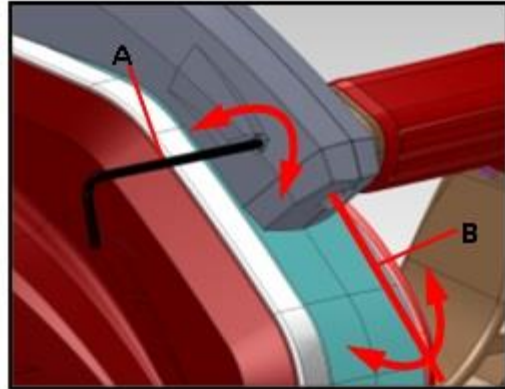

Fig.11

2. Use a small flat blade screw driver to tighten or loosen the the direction adjustment screw (B) to align the laser beam with the actual cut line. **Fig.12.**

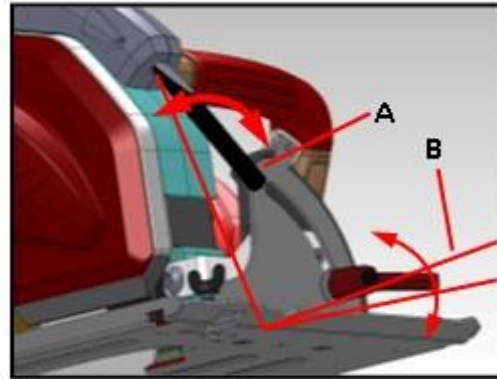

Fig.12

3. Calibrate the saw with the laser by adjusting the guide plate bevel scale to 0° when the laser is aligned with the appropriate notch on the guide plate. **Fig.13.**

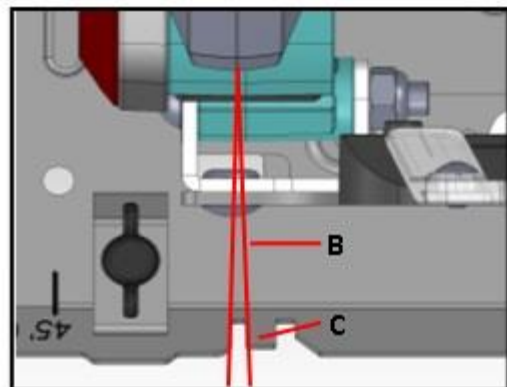

Fig.13

Using the LED Light

The LED light is used to illuminate the cutting area when working in low light conditions. Turn the LED light on by pressing the right switch (A) on the saw handle. Press the switch again to turn off the LED light. **Fig. 14.**

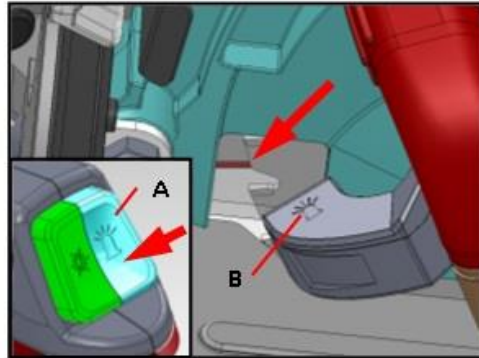

Fig.14

Cutting Depth Adjustment

1. Loosen the lock lever (A) to loosen the base plate. **Fig.15.**

2. Lift the back of the saw away from the baseplate until the desired depth of cut is achieved.

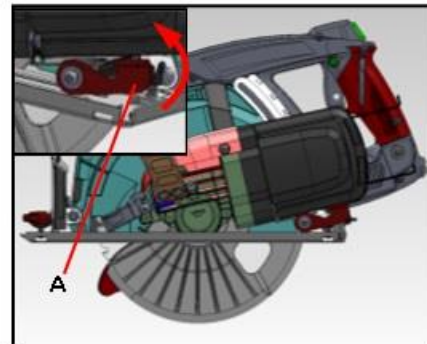

Fig.15

3. Securely re-tighten the lock lever (A) after the depth adjustment is made. **Fig. 16.**

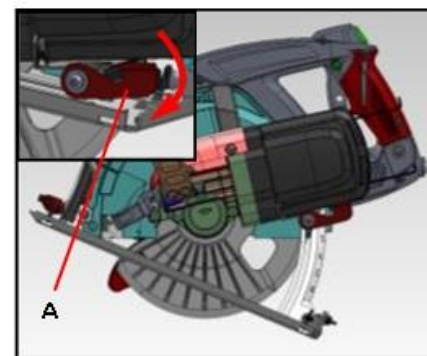

Fig.16

Saw Trigger Switch Operation

Press the stop button (A) and pull the Trigger Switch (B) at the same time to start saw motor.

Saw stops automatically when Trigger Switch is released. **Fig.17.**

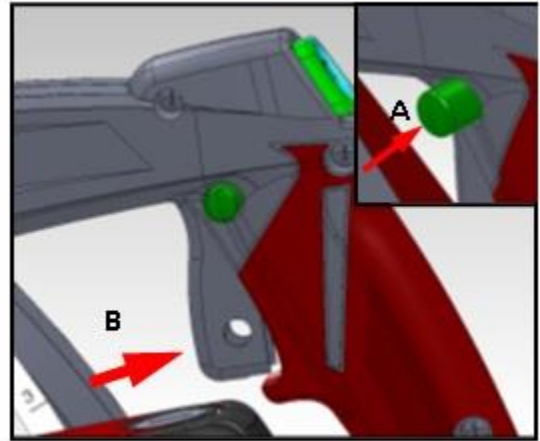

Fig.17

Proper Saw Operation

Use right hand to hold the rear handle (A) and left hand (B) to hold the forward handle. Once the blade reaches full speed, steadily push the saw into the material to be cut. Keep moving smoothly until the cut is finished. **Fig.18.**

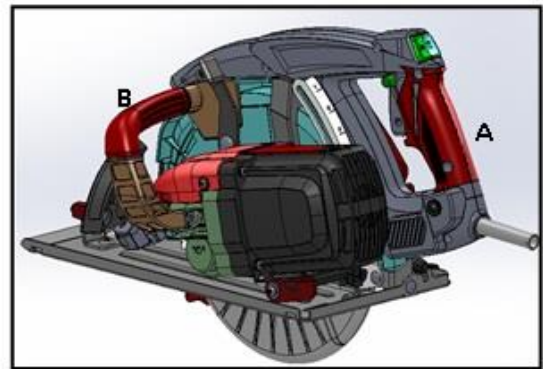

Fig.18

Overload Protection

If the saw motor becomes overloaded – by cutting too fast or material that is too thick or hard – the current consumption of the motor may exceed safe levels. The integrated overload protection circuitry will automatically stop the motor to prevent damage to the saw or injury to the operator. The saw is equipped with a reset button (A) that will allow the motor to restart after an overload shutdown and the motor has cooled sufficiently to be restarted (approximately 3 minutes). **FIG 19.**

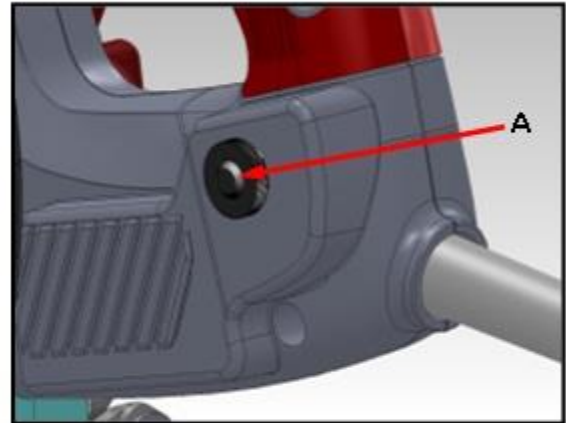

Fig.19

Saw Guide Ruler

The guide ruler is used to make straight cuts along the edge of a plate.

The guide ruler (A) is used on the right of the blade. **Fig.20.**

Attach the guide ruler in the mounting slots at the front of the baseplate and tighten the wing nut to secure it in place at the desired cut width.

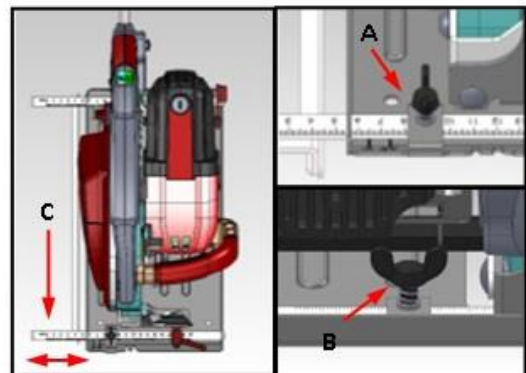

Fig.20

Sighting Notch

The sighting notch (A) near the front of the baseplate provides guidance during free-hand cuts. When performing cuts, the cutting line for the saw blade can be observed via a triangle shaped sighting notch at the front of the base plate. Align the cutting line on the workpiece with the triangle shaped sighting notch at the front of the Base Plate. **Fig. 21.**

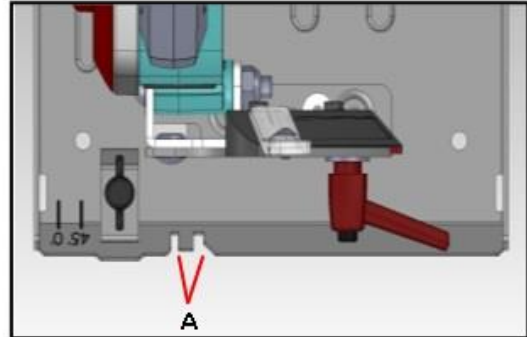

Fig.21

Chip Removal

Chip accumulation can be observed through the clear viewing window on the side of the saw. When the chip collection area reaches half-full, remove the guard by loosening the two bolts. Empty the guard of its contents and re-install. **Figs. 22, 23**



Fig.22

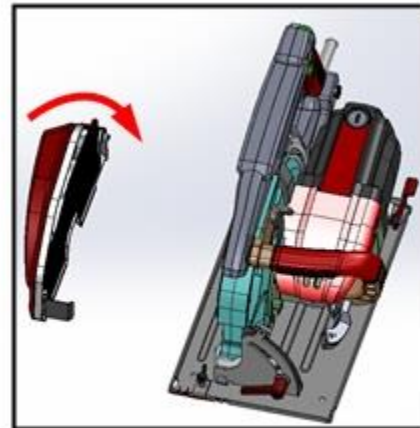

Fig.23

Beware: Always keep the saw away from your body when removing the chip shield to avoid spilling chips on your person or clothing. The chips can be very hot.

SAW MAINTENANCE

General Maintenance

Remove the power cord from the power supply before carrying out any adjustment, servicing or maintenance on your Steelmax saw. Keep the machine clean and never use a saw blade that is damaged or distorted. Replace the saw blade when it becomes dull. For service and replacement pieces see the exploded parts diagram and parts list. Inspect the blade safety cover to assure that it is in good condition and that it moves freely and smoothly. Never use the tool unless the safety cover operates properly and it is in good operating condition.

After operation of the tool has been completed, make sure power plug has been removed from the receptacle and store it in a secure place out of the reach of children. Periodically remove chips in the dust cover and dust from the surface of the power tool with a damp cloth. Keep the tool away from water or oil.

Lubrication

The saw has been properly lubricated during manufacturing and is ready to use. The recommended lubricant is **Mobil HD 85W/140** gear oil.

Check the oil level in the gear box at least once per year. To add oil, unplug the tool and place the saw in a safe horizontal position. Use a 5 mm allen wrench to loosen the screw and remove the oil plug. **Fig 24.** Use a small funnel to add oil to the gear box, taking care to insure that air in the gearbox is evacuated to allow the gearbox to be filled to the appropriate level. The capacity of the gearbox is 1.3 oz (40 cc). Replace the oil plug and tighten with the 5 mm Allen wrench. **DO NOT OVERTIGHTEN THE OIL PLUG. THIS MAY CAUSE THE O-RING TO SEAT IMPROPERLY AND RESULT IN OIL LEAKAGE.**

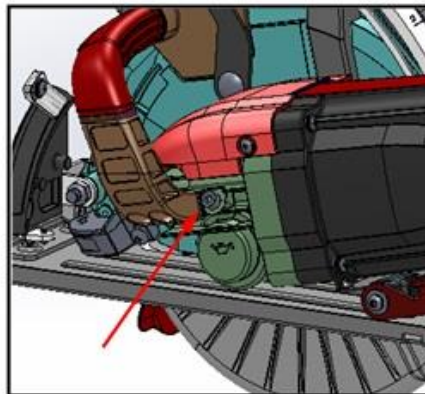

Fig.24

Replacing Carbon Motor Brushes

► **Caution: Disconnect plug from power supply before servicing your saw.**

Your saw's carbon motor brushes must be replaced when they are worn down to 6 mm or less in length from the brush spring. Be sure brushes are clean and slide freely in the brush holder. Always replace both carbon brushes at the same time. Never replace just one of the brushes. Use only approved replacement brushes. Use a flat-blade screwdriver to remove the brush holder cap (A) and remove the worn carbon brushes (B). Insert new carbon brushes and re-secure the brush holder cap. **Fig.25.**

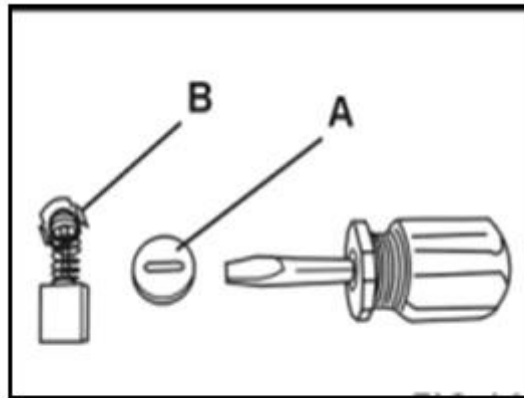

Fig.25



The tools of innovation.

Troubleshooting

ALWAYS DISCONNECT THE SAW FROM POWER SOURCE BEFORE TROUBLESHOOTING

1. Machine will not turn on

- Inspect power cord for damage. Check continuity AND Replace if needed.
- Inspect brushes for excessive wear. Replace if needed.
- Saw may be overheated. Do not exceed 30 minutes continuous run time without letting saw cool down.
- Check trigger switch for continuity. Replace if needed.

2. Losing Power

- Inspect brushes and replace if needed.
- Extension cord too long. Limit cord length to 50' or less.
- Extension cord too thin. Use 14 AWG or heavier.

3. Blade Guard Sticks

- Remove guard, clean and remove any foreign material. Wipe any excess material from guard & face plate. Guard must move freely. Use light grease on mating contact surfaces to aid in movement.
- Check guard return spring for sufficient tension. Replace if spring is weak.
- Check guard for distortion. Replace if distorted or damaged.

4. Blade Spins on Spindle

- Check for proper tightness and installation. Inspect inner blade flange and outer blade flange for wear or damage. Replace if wear is excessive.
- Check flange mating surfaces for flatness. Replace if excessive distortion exists.
- Check to ensure flat washer is present between bolt head and outer blade drive flange.

5. Low Blade Life/Teeth Chipping

- Wrong blade for the type of material. Use only the following Steelmax[®] saw blades.

Steelmax [®] TCT Saw Blades	Steelmax [®] Cermet-Tipped Saw Blades
SM-BL-09 Mild Steel	SM-BL-09-MS-CT Mild Steel
SM-BL-09-AL Aluminum	
SM-BL-09-SS Stainless Steel	SM-BL-09-SS-CT Stainless Steel
SM-BL-09-TS Thin Steel	

- Aggressive contact with blade into material. The blade must be allowed to do the work.
- Too much vibration due to insufficient clamping of workpiece, worn or bent blade, or worn parts (see "Saw Vibrates" below).



The tools of innovation.

6. Saw Vibrates

- Check blade for tightness.
- Inspect inner blade flange and outer blade drive flange for wear or damage. Replace if needed.
- Check to ensure work is properly clamped. Both primary and cut-off piece can cause vibration.
- Check bevel lock and depth lock for tightness.
- Check for missing teeth, bends or cracks in the blade

7. Laser Won't Track

- Adjust Laser alignment with laser turned on.

STEELMAX S9 XP SPECIFICATONS

Rated Voltage	120V, 60Hz, Single Phase
Motor Power	1,800W (2.4 HP)
No Load Motor Speed	2,300 RPM
Motor Amperage	15 Amps
Arbor	1"
Saw Blade Diameter	9" (230mm)
Weight	21 lbs. (9.5 kg)
Max. Cutting Depth at 90 °	3-1/4" (83 mm)
Max. Cutting Depth at 45 °	2-1/4" (56.5 mm)
Max. Plate Thickness	1/4" (6 mm)
Sound power level	95.5 dB(A)
Sound pressure level	93.8 dB(A)

WARNING SYMBOLS AND PRECAUTIONS



Please read the instructions carefully before starting the machine.



Wear hearing protection!



Always wear eye protection when using the machine.



Always keep hands away from the path of the saw blade.



Always disconnect the plug from the power source before carrying out any work on the machine.



Never expose tool to rain.



Laser radiation. Avoid direct eye contact with light source.



Caution: When cutting do not touch the metal parts that may become hot.



Caution: Laser radiation - do not stare into beam



The tools of innovation.

PRODUCT INFORMATION

Thank you for purchasing a Steelmax® product!

Please record the following information and keep this page for your records.

MODEL:	<u>S9 XP METAL CUTTING SAW</u>
SERIAL NUMBER:	_____
PURCHASE DATE:	_____
PURCHASED FROM:	_____