

METAL CUTTING SAW BLADES FROM STEELMAX®

TUNGSTEN CARBIDE & CERMET TIPPED SAW BLADES

CUT MILD STEEL, STAINLESS STEEL, ALUMINUM & THIN STEEL FAST & CLEAN

Steelmax metal cutting saw blades are designed to provide maximum performance when cutting ferrous and nonferrous metals. Compared to abrasive cutting wheels, Steelmax metal cutting saw blades cut faster and more accurately. They also impart less heat and produce no hazardous dust. Steelmax blades are offered with Tungsten Carbide Tips (TCT) or Cermet (Ceramic Metallic) Tips, designed for clean cool cutting of mild steel, stainless steel, aluminum and thin steel. They are suitable for cutting plate, grating, angle, channel, tube, pipe and many other materials.

TCT Blades

Our industry leading Tungsten Carbide Tipped (TCT) saw blades utilize the highest-quality European C6 grade tungsten carbides. With application-specific tooth counts and rake geometry, Steelmax offers a TCT saw blade to cut any material for any job.

FEATURES

- High-quality, European C6 Tungsten Carbide Tips
- Clean cuts with fewer sparks and burrs
- Cool cutting
- Designed with varying tooth counts and rake angles for specific purposes
- Safe alternative to abrasive cutoff wheels

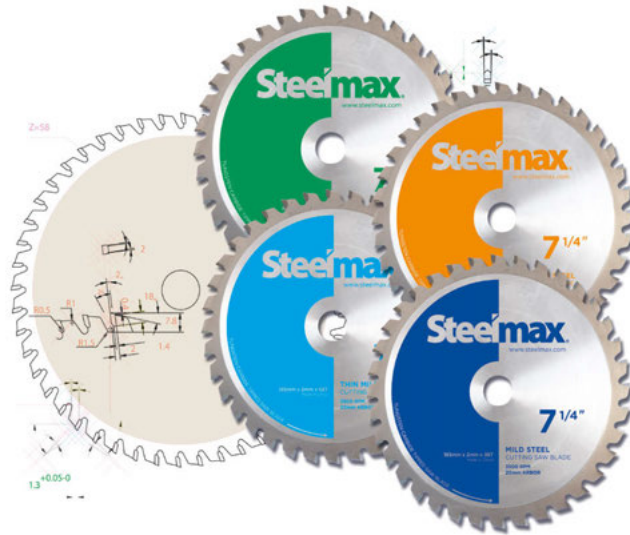

Cermet Tipped Blades

For heavy-duty cutting applications, Steelmax Cermet Tipped saw blades offer superior wear and heat resistance for long cutting life. These blades feature a super-thin kerf for fast, efficient cutting and laser-cut stabilizer slots, reducing dissonant noise and vibration for maximum stability and precise cuts. Our proprietary blade geometry, incorporating wide and shallow tooth pockets, combined with our advanced Triple Chip Grind, provide speed and durability for clean, burr-free cuts in even the hardest alloys.

FEATURES

- Cermet Tips for high impact and wear resistance
- Laser-cut body and stabilizer slots for smooth operation
- Triple Chip Grind for rapid cutting
- Stainless Steel versions feature a two-step blade body and a Fluorine coating for added lubricity for reduced friction
- Proprietary blade geometry (wide & shallow tooth pockets) improves blade stability and durability



Steelmax

The tools of innovation.

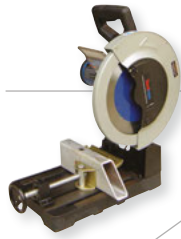

Steelmax S14

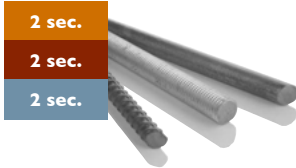

Steelmax S9



Steelmax S7XP

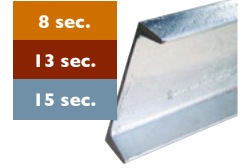
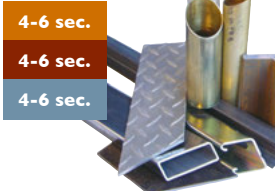

Tungsten Carbide Tipped Metal Cutting Saw Blades

Blade Diameter	Part No.	Teeth	Arbor	RPM (MAX)	Applications
7.0"	SM-BL-07	36T	20 mm	3500	Mild Steel (less than 5/16")
7.25"	SM-BL-07-5	36T	20mm	3500	Mild Steel (less than 5/16")
7.25"	SM-BL-07-5-TS	68T	20mm	3500	Thin Mild Steel (less than 1/4")
7.25"	SM-BL-07-5-AL	54T	20mm	3500	Aluminum (up to 3/8")
7.25"	SM-BL-07-5-SS	48T	20mm	3500	Stainless Steel (less than 1/8")
7.25"	SM-BL-07-5-VVD	40T	20mm	3500	Wood Cutting (framing with wood cover)
8.0"	SM-BL-08	48T	5/8"	3700	Mild Steel (less than 1/2")
9.0"	SM-BL-09	48T	1.0"	2700	Mild Steel (less than 1/2")
9.0"	SM-BL-09-TS	80T	1.0"	2700	Thin Mild Steel (less than 1/4")
9.0"	SM-BL-09-AL	80T	1.0"	2700	Aluminum (up to 3/8")
9.0"	SM-BL-09-SS	54T	1.0"	2700	Stainless Steel (less than 1/8")
12.0"	SM-BL-12	60T	1.0"	1000	Mild Steel (less than 1")
14.0"	SM-BL-14	66T	1.0"	1450	Mild Steel (less than 1")
14.0"	SM-BL-14-TS	90T	1.0"	1450	Thin Mild Steel (less than 1/4")
14.0"	SM-BL-14-AL	100T	1.0"	1450	Aluminum (up to 3/8")
14.0"	SM-BL-14-SS	90T	1.0"	1450	Stainless Steel (less than 1/4")

Cermet Tipped Metal Cutting Saw Blades

Blade Diameter	Part No.	Teeth	Arbor	RPM (MAX)	Applications
7.25"	SM-BL-07-5	36T	20mm	5500	Mild Steel (less than 5/16")
7.25"	SM-BL-07-5-SS	64T	20mm	5500	Stainless Steel (less than 1/8")
9.0"	SM-BL-09	44T	1.0"	3500	Mild Steel (less than 1/2")
9.0"	SM-BL-09-SS	76T	1.0"	3500	Stainless Steel (less than 1/8")
14.0"	SM-BL-14	64T	1.0"	1500	Mild Steel (less than 1")
14.0"	SM-BL-14-SS	110T	1.0"	1500	Stainless Steel (less than 1/4")



The tools of innovation.

For ordering and customer service, or to request detailed product information or demonstration videos, contact:



877-833-5629

STEELMAX.COM

sales@Steelmax.com

Fax: 303-690-9172