

PB10 PIPE BEVELING MACHINE

PNEUMATIC OR ELECTRIC TO MEET USERS SITE CONDITIONS

The Steelmax **PB10** pipe beveling machine is designed for portable use in pipe machining operations. It can be used efficiently by a single operator. It is a heavy-duty I.D. mounted pipe beveler. Self-centering expandable mandrels provide quick and proper alignment to a pipe or a tube prior to machining operations.

The **PB10** is able to bevel, face off, chamfer and counterbore, making all these weld prep operations quick and simple.

Depending on users preferences and site conditions, the **PB10** machine can be operated with a high-quality powerful pneumatic motor or a high-torque electric motor.

FEATURES

- Bevel, face off and counterbore simultaneously
- Standard and custom made tool bits available
- Available in pneumatic or electric versions
- J-Bevel tools available for high welding efficiency

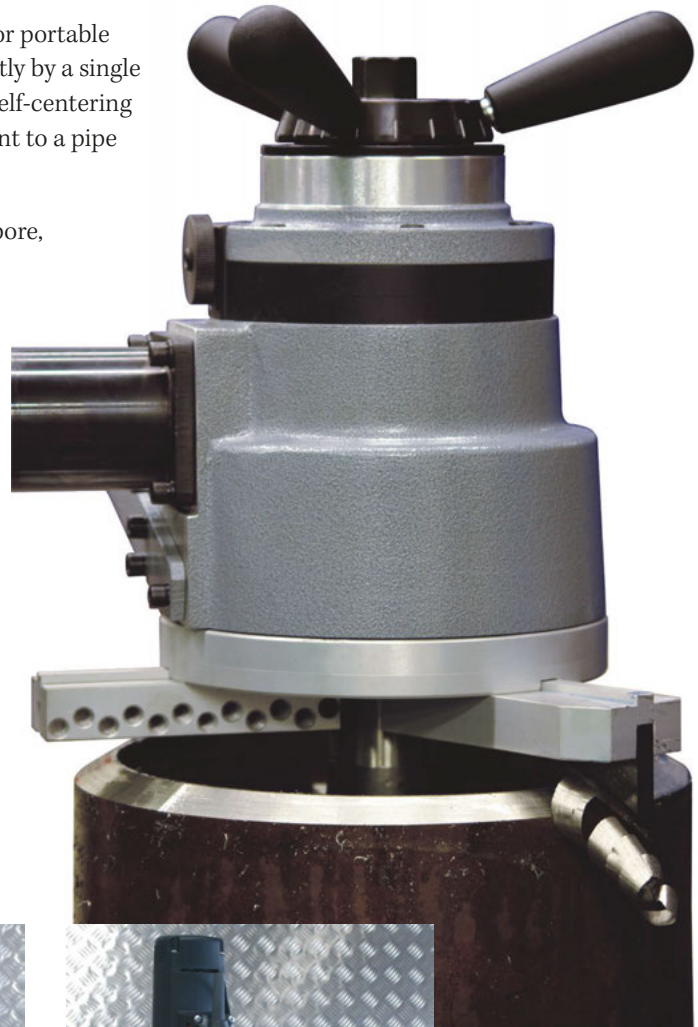

Pneumatic: SM-PB10



Electric: SM-PBE10

Steelmax®

The tools of innovation.

PB10 Technical Specifications

Pipe machining range	Min I.D. – 1.6" (40 mm) Max I.D. – 10-9/16" (269 mm) Wall thickness: up to .80" (20 mm) Minimum Pipe Length: 7-1/2" (190 mm)
Part number	SM-PB10
Pneumatic motor	1500W 2.0 HP
Power requirements	1750 l/min (61.7 cfm) at 630 kpa (90 psi)
Headstock speed range	5 to 18 rpm
Part number	SM-PBE10
Electric motor	1800W
Supply	115V/60Hz or 230V/50Hz
Headstock speed range	14 to 32 rpm



All information is subject to change without notice.

Pneumatic: SM-PB10

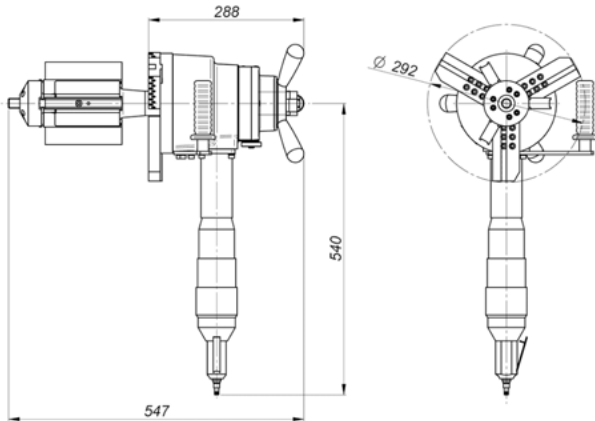

Electric: SM-PBE10

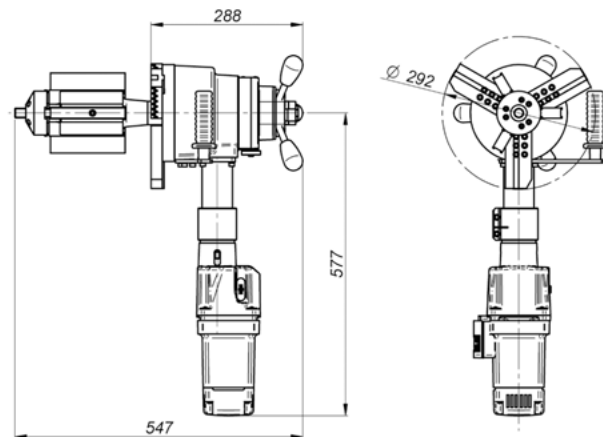

PART NUMBERS & TOOL BITS CODES

SM-NOZ-000019	30° Beveling tool bit, height 1.5" (37 mm)
SM-NOZ-000018	30° Beveling tool bit, height 1.7" (44 mm)
SM-NOZ-000020	37.5° Beveling tool bit, height 1.7" (44 mm)
SM-NOZ-000015	37.5° Beveling tool bit, height 2.1" (54 mm)
SM-NOZ-000021	45° Beveling tool bit, height 2.1" (54 mm)
SM-NOZ-000017	0° Facing tool bit, height 1.2" (30 mm)
SM-NOZ-000023	30° Internal beveling tool bit, height 1.7" (44 mm)
SM-NOZ-000025	30° Internal beveling tool bit, height 2.1" (54 mm)
SM-NOZ-000024	37.5° Internal beveling tool bit, height 2.1" (54 mm)
SM-NOZ-000026	45° Internal beveling tool bit, height 2.1" (54 mm)
SM-NOZ-000001	15° Internal calibration tool bit, height 2.2" (55 mm)
SM-NOZ-000022	15° J-beveling tool bit, height 50mm, radius 0.08" (2 mm)
SM-NOZ-000016	20° J-beveling tool bit, height 50mm, radius 0.31" (8 mm)

Standard shipping set:

- PB10 (without tool bits)
- Wooden crate
- Set of jaws and blocks
- Set of adjustment tools
- Coolant container
- Operator's manual
- Self-centering expandable Mandrel for pipe I.D. Ø 3-5/16 - 10-9/16" (84 - 269 mm)
SM-ZSP-0200-04-00-00-1

Beveling Tool Bits

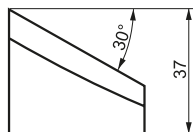

B30/37

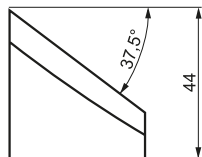

B375/44

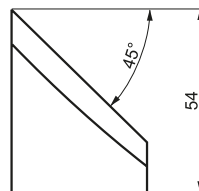

B45/54

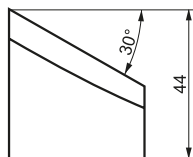

B30/44

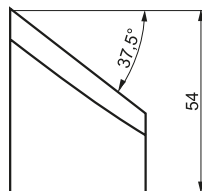

B375/54



Internal Beveling Tool Bits

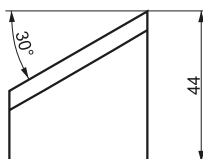

IB30/44

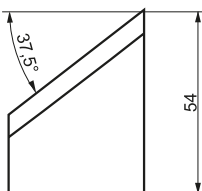

IB375/54

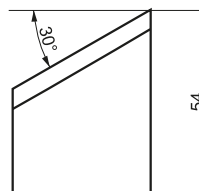

IB30/54

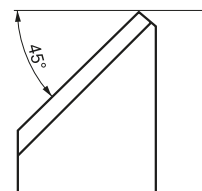

IB45/54

PORTABLE BEVELING MACHINE FROM STEELMAX®

J-Beveling Tool Bits

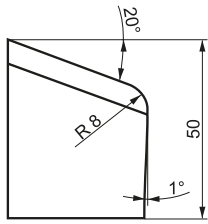

J20/50/R8

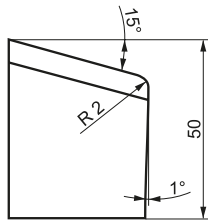

J15/50/R2

ID Chamfer Tool Bit

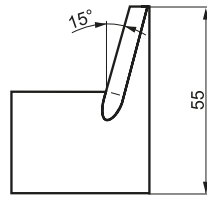

IC15/55

Facing Tool Bit

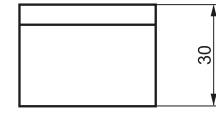

F0/30

Additional Equipment:

- | | |
|-------------------------------|---|
| SM-PRK-0447-00-00-00-2 | Flange facing attachment with cutting capacities 3-9/16" to 20" (90 - 508 mm), delivered in a metal box |
| SM-PRK-0463-00-00-00-1 | Out of round attachment set includes large mandrel for pipe ID Ø 5" to 11-5/8" (126 - 296 mm), delivered in a metal box |
| SM-ZSP-0200-05-00-00-2 | Self-centering expandable Mandrel for pipe I.D. Ø 1-1/2 - 3-3/8" (38 - 86 mm) |
| SM-ZST-0200-13-00-00-2 | Extension set for ID Ø up to 14" (355 mm) includes 3 steel tool holders and jaws 7-12, delivered in metal box |
| SM-ZST-0200-12-00-00-0 | Electric motor set 230V |
| SM-ZST-0200-12-00-00-1 | Electric motor set 115V US plug |
| SM-ZSP-0200-03-00-00-0 | Air Motor Assembly |

Custom made versions of toolbits are available on request.

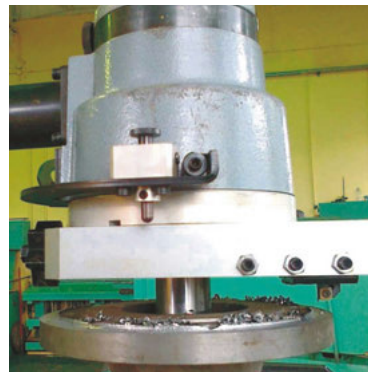
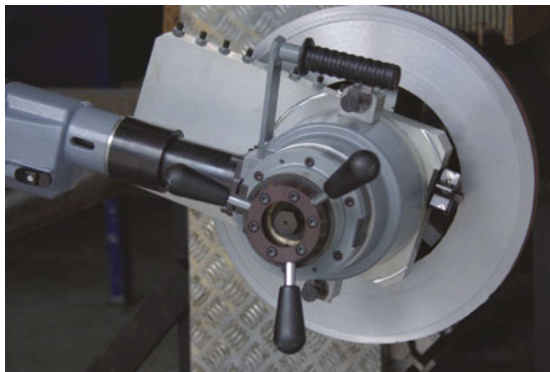

Steelmax

The tools of innovation.



For ordering and customer service, or to request detailed product information or demonstration videos, contact:

877-833-5629

STEELMAX.COM

sales@Steelmax.com

Fax: 303-690-9172